

日益國寶
RIYIGUOBAO

東莞市日益國寶過濾機有限公司
DONGGUAN RIYI GUOBAO FILTER LITTED

蘇州日益國寶泵業有限公司
SUZHOU RIYI GUOBAO PUMP LITTED

华南厂：广东省东莞市寮步镇乐和二路2号
(伟兴产业园)1号楼
South China Factory: Building 1, No. 2 Lehe 2nd Road
(Weixing Industrial Park), Liaobu, Dongguan, Guangdong
电话/TEL: 0769-82380366 13632892117

华东厂：江苏省苏州市昆山市陆家镇金阳东路1068号
国瑞创业园13号房
East China Factory: Building 13, Guorui Pioneering Park,
No. 1068 East Jinyang Road, Lujia, Kunshan, Jiangsu
电话/TEL: 0512-57878871 15151610797

24小时服务电话/24 Hours: 400-072-2728
Http://www.riyiguobao.com
E-mail:suzhou@riyiguobao.com



ACID AND ALKALI RESISTANT PUMP



CHEMICAL LIQUID MEDICINE FILTER



MAGNETIC PUMP

日益國寶
RIYIGUOBAO

化工界頂尖 — 耐酸碱的權威
Top of the Chemical Industry, the
authority on acid and alkali resistance

化學藥液過濾機
耐酸碱泵·磁力泵

CHEMICAL LIQUID MEDICINE FILTER
ACID AND ALKALI RESISTANT PUMP
MAGNETIC PUMP



日益國寶泵業有限公司
RIYI GUOBAO PUMP LITTED

◎ 保留产品设计改进权，如有变动，恕不另行通知。
Retention of product design improvements, are subject to
change without prior notice.

♻️ 采用生态纸印刷。 Using ecological paper printing.

化學藥液過濾機 · 耐酸碱泵 · 磁力泵

Chemical Liquid Medicine Filter, Acid And Alkali Resistant Pump, Magnetic Pump



东莞市日益国宝过滤机有限公司、苏州日益国宝泵业有限公司 是专业从事化学药液过滤机、耐酸碱泵、P C B 设备、电镀设备等研发、生产、销售、服务于一体的股份制企业。公司拥有全套现代化检验仪器与生产设备及一大批具有十几年产品专业知识和经验丰富的工程师，产品畅销全国各地，并远销东南亚及欧美等国，深受广大用户的青睐。

公司将继续保持和发扬企业的优良传统，本着“质量第一，信誉第一，客户第一”的经营方针，以客户满意为目标，为广大客户提供更好的产品和更贴心的服务。

日益國寶

RIYIGUOBAO



● 华南厂 Southern China Factory

行業領先技術 / 科技化 / 專業化
Leading Industrial Technology /Hi-tech/ Professional



DONGGUAN RIYIGUOBAO FILTER CO., LTD. & SUZHOU RIYIGUOBAO PUMP CO.,LTD. is a joint-stock company specializing in R&D, production, sale and service of chemical liquid medicine filters, acid and alkali resisting pumps, PCB equipment, electroplating equipment and so on. Our company has a whole set of modern inspection instruments and production equipment plus a number of engineers having professional knowledge and over ten years of experience in products. Our products are well-received throughout the country and also exported to Southeast Asia, Europe and America, which have won deep favor of users.

Our company will continue to maintain and carry forward our fine traditions. With the operational policy: quality, credit and customers first, and the objective: customer satisfaction, we'll provide better products and closer service for customers.



● 华东厂 East China Factory

MP(MD)、MP(MD)-F 系列磁力驅動循環泵 MP(MD), MP(MD)-F SERIES MAGNETIC DRIVE CIRCULATING PUMP



MP(MD)-10R



MP(MD)-20R



MP(MD)-40R



MP(MD)-70R



MP(MD)-100R

- MP(MD)、MP(MD)-F系列磁力泵结构小巧，绝对防漏，在各个行业广泛应用，以其耐腐蚀性和耐用性而得到广大用户的赞誉。主要材质使用GFRPP、PVDF，可以用来输送多种腐蚀性的液体。MP(MD)、MP(MD)-F系列因其结构小巧，非常适合用作照相冲洗、电镀设备、PCB设备的液体循环。
- The MP(MD), MP(MD)-F series magnetic pump has a compact structure and 100% leakproof, which is widely applied in various industries and spoken highly of by users for its corrosion resistance and durability. Mainly adopting such materials as GFRPP and PVDF, it's available for transporting many kinds of corrosive liquids. Due to its compact structure, the MP(MD), MP(MD)-F series is very applicable for liquid circulation in photo developing, electroplating equipment and PCB equipment.

規格齊全 Complete Specifications

- MP(MD)、MP(MD)-F系列泵的最大流量由每分钟5升至220升，有软管接口和螺纹接口选择，MP(MD)、MP(MD)-F系列泵适用于酸碱类的液体输送，按液体比重而选择不同的叶轮，可输送多种高比重液体而不致超负载。
- The MP(MD), MP(MD)-F series pump's maximum flow is up to 220L/min from 5L/min. With such options as hose and thread connections, it's applicable for transporting acid and alkali liquids. Different impellers can be selected, subject to specific gravity of liquids, to transport many kinds of liquids with high specific gravity without overload.

工作原理 Working Principle

- MP(MD)、MP(MD)-F系列磁力泵是被一对连在叶轮和电机轴上的磁铁驱动的。在结构上不像传统离心泵，无轴封。泵腔被后壳隔开，电机带主动磁旋转。主动磁和被动磁的耦合力矩带动叶轮旋转，从而实现液体输送。
- The MP(MD), MP(MD)-F series magnetic pump is driven by a pair of magnets connected on impeller and motor shaft. Unlike the traditional centrifugal pump, it's glandless for its structure. Its chamber is separated by the rear casing. Its motor is provided with active magnetic rotation. The active and passive magnetic coupling torque drives the impeller to rotate, thus achieving the liquid transportation.

結構說明 SPECIFICATION COMPLETE

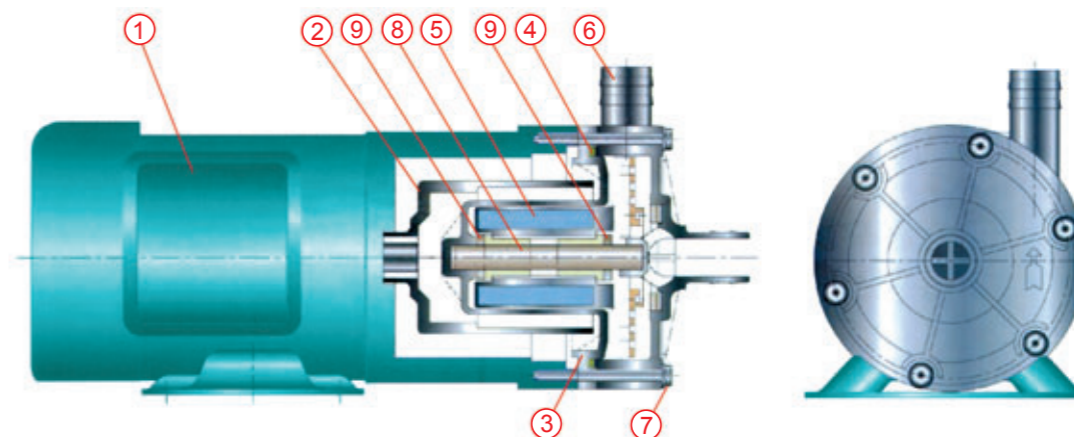

编号 No.	1	2	3	4	5	6	7	8	9
名称 Name	马达 Motor	外驱动磁铁 Drive Magnet	后盖 Rear cover	封盖O环 Casing O-ring	叶轮 Impeller	前盖 Front casing	前盖与马达固定螺丝 Bolts	轴心 Shaft	双止推垫片 Washer
材质 Material	防蚀涂装马达	磁铁 Magnet	FRPP/PVDF/CFRPP	NRB/EPDM/VITON	FRPP/PVDF/CFRPP	FRPP/PVDF/CFRPP	SUS304	Ceramic/Titanium/SSIC	Ceramic/SSic

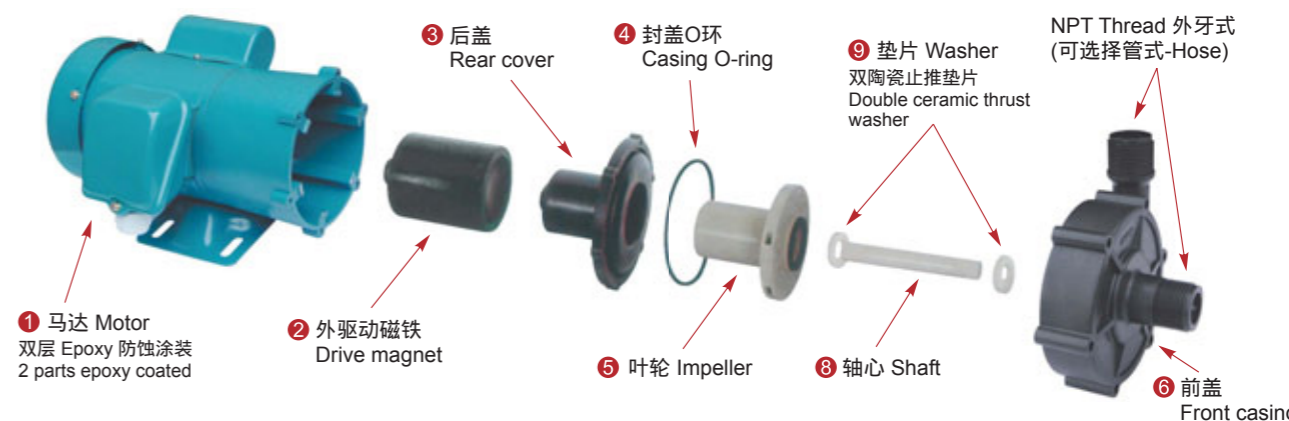

MP(MD)系列泵是簡單、堅固、耐用做的最好的磁力驅動泵之一

- 马达为坚固的全封闭式风扇冷却结构，而且是双层的epoxy涂装。
- MP(MD)系列泵加上陶瓷轴心及双陶瓷止推垫片，使得其与同级产品比较起来，运转更顺畅及增加其耐久性。
- 此泵为无轴封设计，可供货的材质有FRPP、PVDF、CFRPP。
- 此泵可供货的密封材质有VITON、NBR或EPDM。
- 输送的药水不会与金属零件接触。

The MP(MD) series pump is one of the best magnetic drive pumps in simplicity, firmness and durability.

- The motor is of solid TEFC construction and is painted with 2 parts epoxy paint.
- The MP(MD) series pumps incorporates ceramic shaft and dual thrust bearings to give smoother running and increased durability compared to other pumps in its class.
- The pumps are seal-less and are available in FRPP, PVDF, CFRPP.
- The pumps are available with VITON, NBR or EPDM gaskets.
- The pumps have no metallic parts in contact with the solution being pumped.

型號意義 MODEL EXPLANATION

MP(MD) - 20R X - 100

- 无代号电压为220V, 100-100V, 380-380V, 440-440V
Voltage 220V, if code N/A; 100-100V, 380-380V, 440-440V
- 无代号为普通型; Common type, if code N/A;
- M为进出口用螺纹接口; M for thread connection inlet/outlet;
- X为大流量型; Z为高扬程型; X for large-flow type; Z for high head lift type;
- T为特殊用途; N为改进型 T for special purpose; N for improved type
- 产品规格 Product specification
- MP(MD)塑料磁力驱动循环泵 (PP) MP(MD) Plastic Magnetic Drive Pump (PP)
- MP(MD)-F氟塑料磁力驱动循环泵 (PVDF)
- MP(MD)-F Fluoroplastic Magnetic Drive Circulating Pump (PVDF)

過流端材質 FLOW PASSAGE END MATERIAL

名称 Name	材质 Material	名称 Name	材质 Material
泵壳 Pump casing	GFRPP、CFRPP、PVDF	轴承 Bearing	PTFE、氧化铝陶瓷 Alumina ceramic
叶轮 Impeller	GFRPP、CFRPP、PVDF	止推环 Thrust ring	氧化铝陶瓷 Alumina ceramic、PE
隔离套 Spacer sleeve	GFRPP、CFRPP、PVDF	密封圈 Gasket ring	FKM、EPDM
泵轴 Pump shaft	氧化铝陶瓷 Alumina ceramic		

技術參數 TECHNICAL PARAMETERS

型号 Model	软管连接 Hose		螺纹连接 Threaded		最大流量 Max Flow (L/min)	最高扬程 Max Head (m)	标准工况点 Operating Point (m-L/min)	温度范围 Temp (°C)	比重限制 Specific Gravity	马力 Power (W)		
	入口 Inlet	出口 Outlet	入口/出口 Inlet/Outlet	联管节 Union						输出 Output	输入 Input	相数 Phase
MP(MD)-6	14mm	14mm	G 1/2	-	8	1	0.8-2.8	0-80°C	1.2	3	22	1
MP(MD)-6Z	14mm	14mm	G 1/2	-	5.5	2.1	1.5-3.2	0-80°C	1.1	3	24	1
MP(MD)-10	14mm	14mm	G 1/2	-	11	1.5	1-5	0-80°C	1.1	6	35	1
MP(MD)-15R(M)	14mm	14mm	G 3/4	13mm	16	2.4	1.5-8	0-80°C	1.3	10	26	1
MP(MD)-20R(M)	18mm	18mm	G 3/4	16mm	27	3.1	2-17	0-80°C	1.1	20	40	1
MP(MD)-20RX(M)	26mm	26mm	G 1	20mm	46	1.8	1-30	0-80°C	1.3	20	40	1
MP(MD)-20RZ(M)	18mm	18mm	G 3/4	13mm	10	4.9	4-6	0-80°C	1.1	20	40	1
MP(MD)-30R(M)	20mm	20mm	G 3/4	16mm	32	3.8	2.5-16	0-80°C	1.3	45	60	1
MP(MD)-30RX(M)	26mm	26mm	G 1	20mm	62	2.9	2-32	0-80°C	1.1	45	70	1
MP(MD)-30RZ(M)	18mm	18mm	G 3/4	13mm	15	8	6-10	0-80°C	1.0	45	70	1
MP(MD)-40R(M)	20mm	20mm	G 3/4	16mm	45	4.6	4-22	0-80°C	1.1	65	90	1
MP(MD)-40RX(M)	26mm	26mm	G 1	20mm	75	3.3	2-47	0-80°C	1.1	65	85	1
MP(MD)-40RZ(M)	22mm	22mm	G 3/4	16mm	22	10	8-10	0-80°C	1.1	65	110	1
MP(MD)-40RZ-5(M)	22mm	22mm	G 3/4	16mm	12	11.5	10-8	0-80°C	1.1	65	110	1
MP(MD)-55R(M)	26mm	26mm	G 1	20mm	60	5.6	4-30	0-80°C	1.2	90	130	1 or 3
MP(MD)-55R-5(M)	26mm	26mm	G 1	20mm	70	8.2	4-45	0-80°C	1.2	90	170	1 or 3
MP(MD)-70R(M)	26mm	26mm	G 1	20mm	86	6.7	4-50	0-80°C	1.0	150	265	1 or 3
MP(MD)-70RZ(M)	20mm	20mm	G 3/4	16mm	40	14.3	12-24	0-80°C	1.0	180	275	1 or 3
MP(MD)-100R(M)	26mm	26mm	G 1	20mm	120	8.6	6.5-60	0-80°C	1.2	260	345	1 or 3
MP(MD)-100R-5(M)	26mm	26mm	G 1	20mm	135	11.7	9-60	0-80°C	1.1	260	345	1 or 3
MP(MD)-100RX	32mm	32mm	G 1 1/4	32mm	170	9	5-100	0-80°C	<1.3	260	345	1 or 3
MP(MD)-120R	-	-	G 1 1/2	36mm	220	10.5	6-140	0-80°C	<1.3	370	-	1 or 3
MP(MD)-120RT	-	-	G 2 1/4	48mm	220	10.5	6-140	0-80°C	<1.3	370	-	1 or 3

• 比重极限是当介质粘度为1mPa·s及在最大流量时的数值。
The specific gravity limit refers to the value on medium viscosity 1mPa·s and the maximum flow.

• 电动输入功率为输送清水时的数值。
The electric input power is the value on transporting clear water.

性能曲綫 PERFORMANCE CURVE

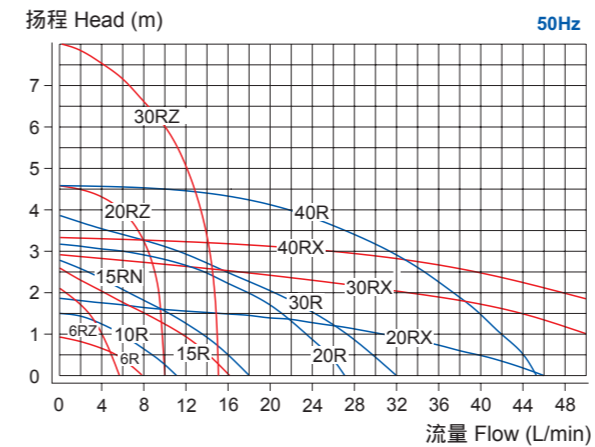

MP-6R~MP-40R

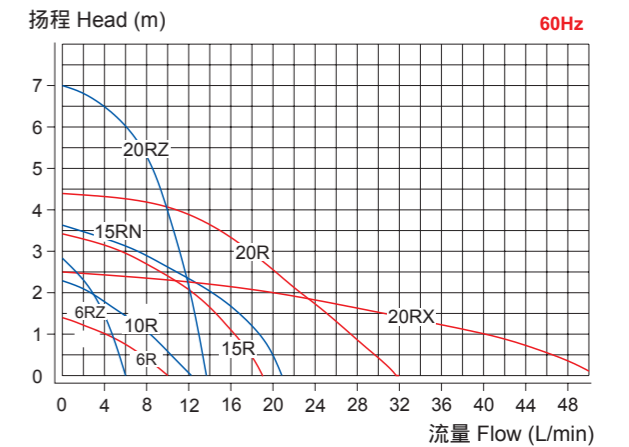

MP-6R~MP-20R

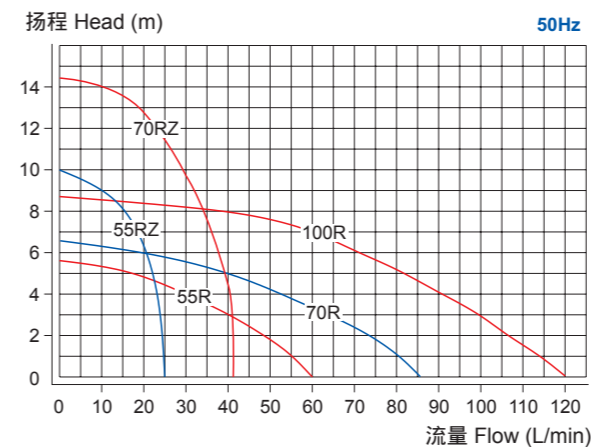

MP-55R~MP-100R

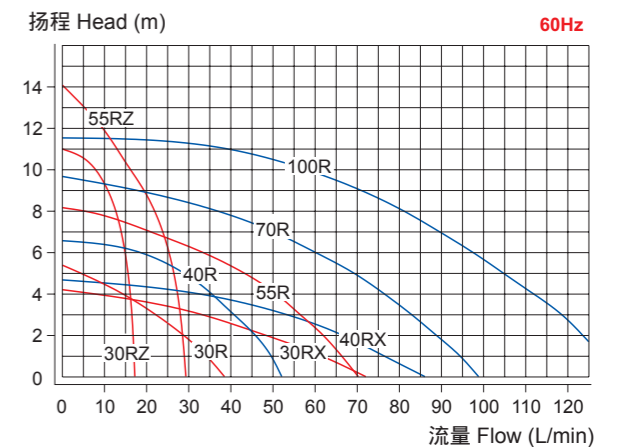

MP-30R~MP-100R

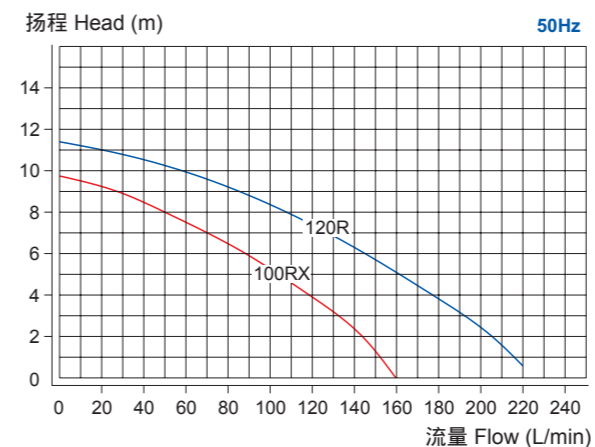

MP-100RX~MP-120R

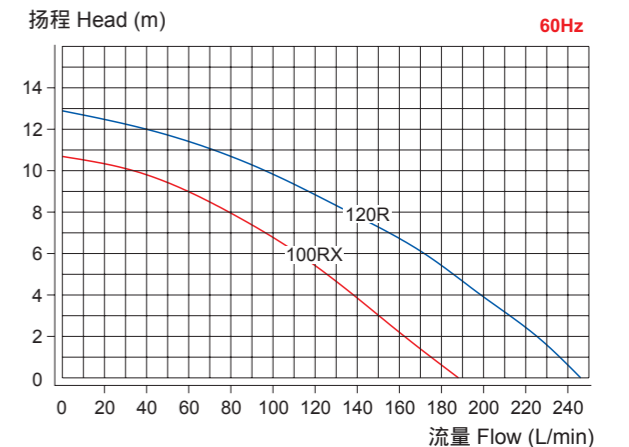

MP-100RX~MP-120R

安裝尺寸 INSTALLATION DIMENSIONS

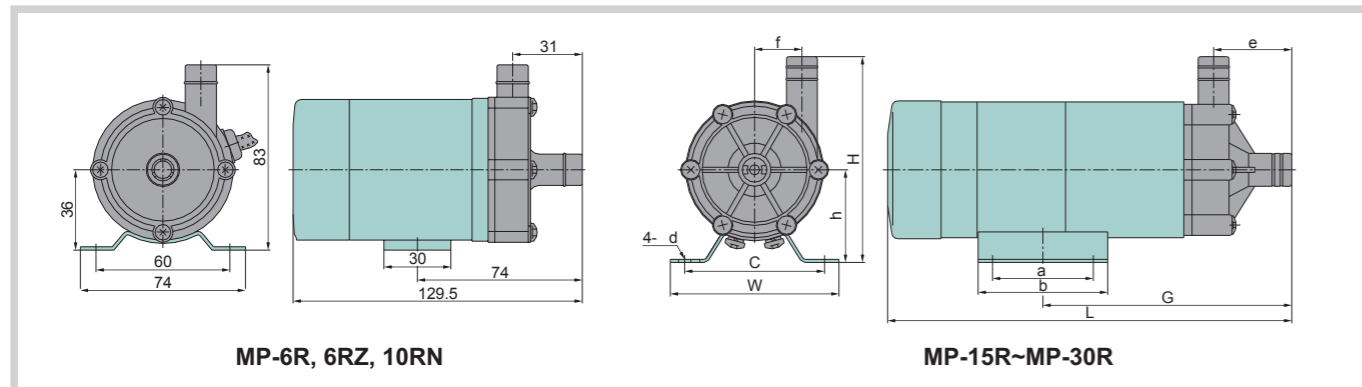

型号 Model	a	b	c	d	e	f	G	h	H	W	L
MP-15R	49	63	68	6	38	23	121	45	100	82	196.5
MP-15RN	49	63	68	6	39.5	24.5	117.5	46	100	82	180
MP-20R	30	50	68	5.5	38.5	28.5	131.5	56	116	85	209
MP-20RX	30	50	68	5.5	46.5	/	143	56	130	85	220.5
MP-20RZ	30	50	68	5.5	40	40	134	56	126	85	212
MP-20RM	30	50	68	5.5	34	28.5	127	56	117	85	204.5
MP-30R	40	64	100	9	48	30	166.5	60	130	120	249.5
MP-30RX	40	64	100	9	48	/	169.5	60	138	120	252.5
MP-30RZ	40	64	100	9	40	40	151	60	130	120	234
MP-30RM	40	64	100	9	48	30	166.5	60	130	120	249.5

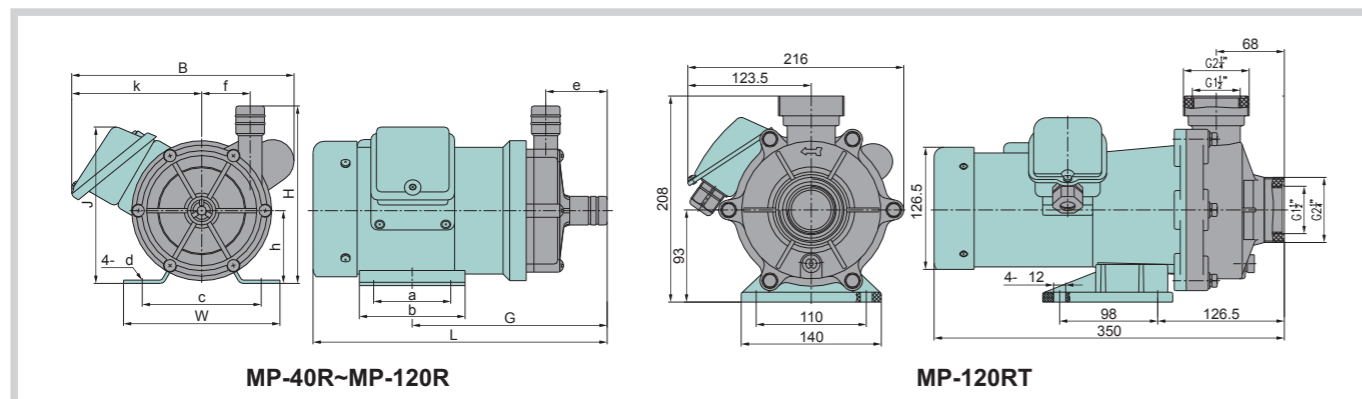

型号 Model	a	b	c	d	e	f	G	h	H	W	L	B	J	k
MP-40R	40	64	100	9	48	30	167.5	60	130	120	274	/	118	60
MP-40RX	40	64	100	9	48	30	170.5	60	138	120	277	/	118	60
MP-40RM	40	64	100	9	48	30	167.5	60	130	120	274	/	118	60
MP-55R	40	64	100	9	56.5	43	198.5	65.5	161	120	275	/	140	54
MP-55RZ	40	64	100	9	56.5	43	198.5	65.5	161	120	275	/	140	54
MP-70R	70	96	108	9.5	55.75	44	177	66	161	142	267	202	142	118
MP-70RM	70	96	108	9.5	52.75	44	174	66	156	142	264	202	142	118
MP-70RZ	70	96	108	9.5	41.6	47.5	163	66	167	142	253.1	202	142	118
MP-100R	70	100	110	9	66	44	195.5	74	174	156	322	202	150	118
MP-100RM	70	100	110	9	66	44	195.5	74	174	156	322	202	150	118
MP-100RX	70	100	110	9	63	40	196.5	74	174	156	323	205	167	124
MP-120R	98	130	110	12	80	51	184.5	93	208	140	359	216	187	123

MPH 系列磁力驅動循環泵

MPH SERIES MAGNETIC DRIVE CIRCULATING PUMP



- MPH采用了崭新的针点接触系统技术，使用耐空转材料，使耐空转性能及可靠性得以提高，电机功率0.4kW~3.7kW，能满足中等流量耐腐蚀泵的需求。
- The MPH adopts the brand-new probe tip contact system technology and the material resistant to idle running so that it's better in idle running resistance and reliability. The motor power is 0.4kW-3.7kW, which can meet needs for medium-flow anti-corrosive pumps.

高耐腐蝕性 Strong Corrosion Resistance

- MPH的泵壳、叶轮和磁囊以聚丙烯塑料或PVDF制成，其他接触液体的部件由高耐腐蚀材料，如碳、陶瓷、PTFE等制成，可输送各类型的酸碱化学液体。
- The MPH pump's casing, impeller and magnetic capsule are made of Polypropylene plastic or PVDF. The rest parts contacting the liquid are made of strong corrosion resistant materials, such as carbon, ceramic and PTFE, thus being able to transport different kinds of acid and alkali chemical liquids.

高耐用性 Strong Durability

- MPH泵的塑料部件为玻璃纤维增强或碳纤维增强。此外，也充分考虑了轴的机械强度及安全性，耐用性大大提高。
- The MPH pump's plastic part is reinforced with fiberglass or carbon fiber. Besides, full consideration is taken into the shaft's mechanical strength and safety, thus its durability is improved substantially.

針點接觸系統，使用耐空轉材料，空轉不成問題 Probe tip contact system and material resistant to idle running, thus free of idle running problem

- 一般磁力驱动泵，内部零件经常因转动而产生摩擦发热，最终会导致熔化。采用了针点接触系统和使用耐空转材料后，可防止这些问题的出现。在空转的情况下，只有叶轮锥垫和泵轴前缘接触在一起，磁囊与后壳从不接触，大大地减少磨擦，而耐空转材料不会熔化。
- For a common magnetic drive pump, its internal parts may rub and heat due to frequent rotations, thus leading to melting finally. Such problems can be prevented by means of adopting probe tip contact system and material resistant to idle running. In case of idle running, only the impeller conical gasket contacts the front end of the pump shaft while the magnetic capsule never contacts the rear casing, thus friction will be reduced a lot and the material resistant to idle running will not be melted.

結構說明 SPECIFICATION COMPLETE

- 不需要磨耗的機械軸封，此無軸封設計排除了機械軸封所可能導致的洩漏問題，且用途廣泛。
- NO friction seal, this seal-less construction eliminates the leakage may caused by mechanical seal and can be applied to various applications.



① 法蘭以橢圓型螺絲孔設計，適合DIN, JIS及ANSI等各種尺寸，安裝便利。
Oval-shaped flange holes suit different standards like DIN, JIS and ANSI. Easy for mounting.



② 泵體採用GFRPP、CFRETFE、CFRPP、PVDF等各種塑膠材料射出成型，可適用於大部分的化學藥水。
Available engineering plastic GFRPP, CFRETFE, CFRPP and PVDF prevent the attack of most chemicals.



③ 新型葉輪的嵌入式結構大大地強化了葉輪的強度，也延長其使用壽命。

New embedded construction makes the impeller extremely strong and also extends its service life.



⑤ 高純度氧化鋁，碳化硅，各種材質的磨耗零件使泵的耐腐蝕力更優良。
High-purity aluminum oxide, SSIC and various other low friction part materials are available that compliment the pump's anti-corrosive features.

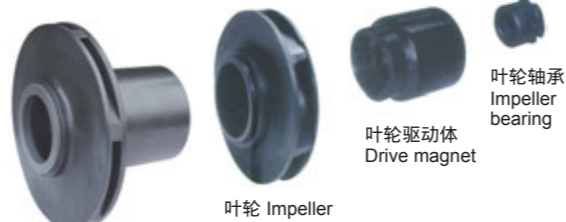
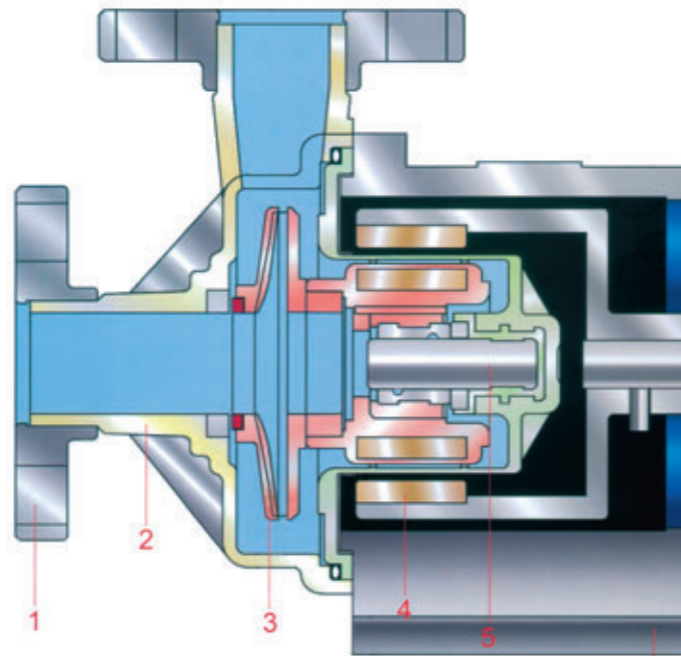

④ 採用強力磁鐵，體積小，磁力強，驅動力大，永不退磁。
Small, powerful magnets maximizes efficiency and long term use.



⑥ 獨特設計以塑膠和球墨鑄鐵接合座製成，耐腐蝕性優良，輕便，強度更佳，塑膠接合座上有視窗設計，可目視運轉方向。
Unique engineering plastic bracket construction, excellent in anti-corrosion, light and handy and more powerful strength. Small window enables you to check the rotating direction easily.

型號意義 MODEL EXPLANATION

MPH - F - 44 - 0 - C - C - V - 6 - V38 - A

1. 機型編號 Model

MPH

2. 泵體材質 Material

PP-PP P-PVDF
F-GFRPP E-CFRETFE

3. 出入口徑 In-outlet

25-25×25mm 44-40×40mm
45-40×50mm 56-50×65mm
66-65×65mm

4. 馬力 Power

0-1/2HP 1-1HP 2-2HP
3-3HP 5-5HP 7-7.5HP

5. 泵軸材質 Spindle

C-陶磁 Ceramic S-碳化矽 SIC

6. 軸承材質 Bearing

A-陶磁 Ceramic P-鐵弗龍 PTFE
C-碳素 Carbon S-碳化矽 SIC

7. 橡膠材質 Rubber

V-VITON E-EPDM P-PFA

8. 頻率 Frequency

5-50Hz 6-60Hz

9. 電壓 Voltage

V38-220V/380V/3Ø
V41-208V/415V/3Ø
V44-240V/440V/3Ø

10. 藥液比重 Specific Weight

50Hz: A-1.2 B-1.5 C-2.0
60Hz: D-1.2 E-1.5 F-2.0

過流端材質 FLOW PASSAGE END MATERIAL

零件名稱 Description	MPH-PP Series			MPH-F Series			MPH-P Series			MPH-E Series
	CC	CP	CA	CC	CP	CA	CC	CP	CA	SS
前蓋 Front Casing	PP			GFRPP			PVDF			CFRETFE
前蓋止推環 Front Thrust Ring				Ceramic						SIC
出入口環 In-outlet O-ring				EPDM / VITON / PFA						
出入口法蘭 In-outlet Flange	PP			CFRPP			PVDF			CFRETFE
葉輪 Impeller	CFRPP									
耐磨圈 Mouth Ring				PTFE						SIC
軸承 Bearing	Carbon	PTFE	Ceramic	Carbon	PTFE	Ceramic	Carbon	PTFE	Ceramic	
被動磁鐵 Magnet Capsule	PP			PP			PVDF			CFRETFE
後蓋 Rear Casing				GFRPP						
軸心 Spindle				Ceramic						SIC
密封環 O-ring				EPDM / VITON / PFA						
驅動磁鐵 Drive Magnet				Isotropic Ferrite						
基座 Baseplate				GFRPP / FC						

技術參數 TECHNICAL PARAMETERS

50HZ

型號 Model	標準尺寸 入口×出口 Inlet×Outlet	葉輪大小 Impeller Size	比重限制 Specific Gravity	最小流量-最高揚程 Min Flow-Max Head (L/min-m)	標準流量-揚程 Standard Flow-Head (L/min-m)	最大流量 Max Flow (L/min)	馬達功率 Power (kW)	重量 Weight (kg)
MPH-440	G1 1/2×G1 1/2 (40×40)	5	1.1	10-12.5	150-8.5	280	0.4,2P	11.5
MPH-441			1.1	10-18	200-12	330	0.75,2P	18
MPH-452	G2×G1 1/2 (50×40)		1.1	20-23	200-18.5	400	1.5,2P	23
MPH-453			1.1	20-24	300-20.5	500	2.2,2P	25
MPH-455	G2 1/2×G2 (65×50)		1.1	50-29	400-25.5	600	3.7,2P	47
MPH-563			1.1	100-22	500-12	750	2.2,2P	29
MPH-565	G2 1/2×G2 1/2 (65×65)		1.1	50-36	500-26	800	3.7,2P	48
MPH-663			1.1	100-22	670-12	1050	2.2,2P	31
MPH-665			1.1	100-28	900-15	1100	3.7,2P	49
MPH-667			1.1	100-32	1200-15	1350	5.5,2P	60

- 以上所示的比重極限是當軸功率為最大、液體粘度為1mPa.S(1cp)時的數值。
The specific gravity limit listed above is the value on the maximum shaft power and liquid viscosity 1mPa.S(1cp).
- 液體溫度範圍：0-80 Liquid temperature range: 0-80°C
- 漿液：請與我們聯絡 For slurry, please contact us.

性能曲綫 PERFORMANCE CURVE

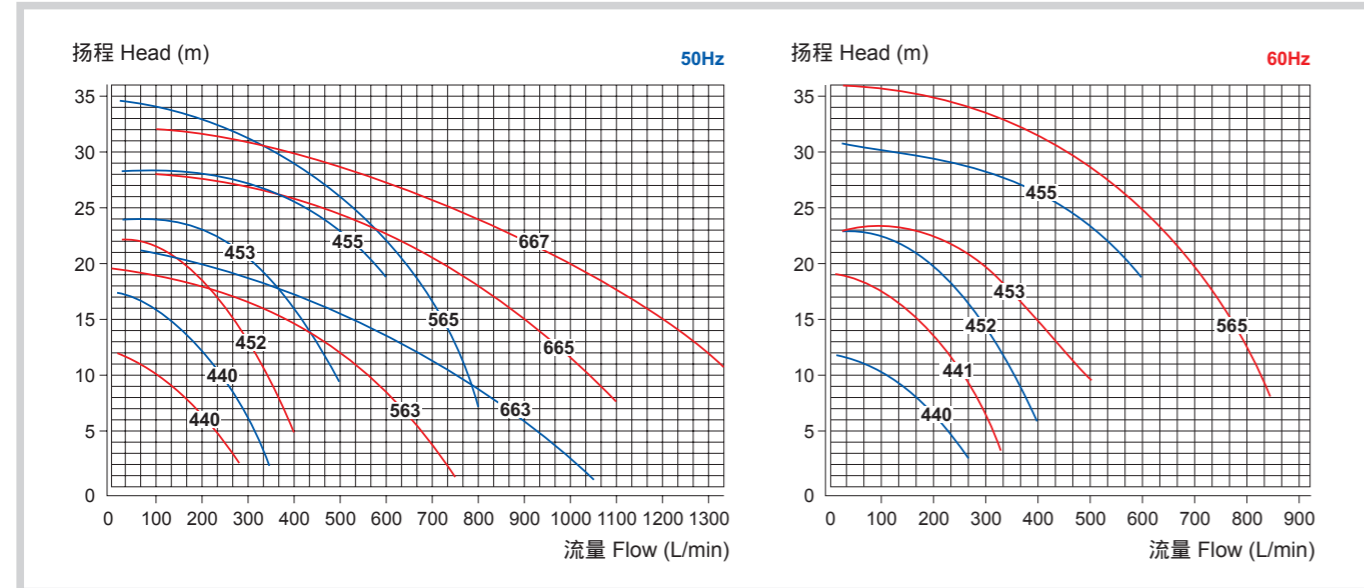

安裝尺寸 INSTALLATION DIMENSIONS

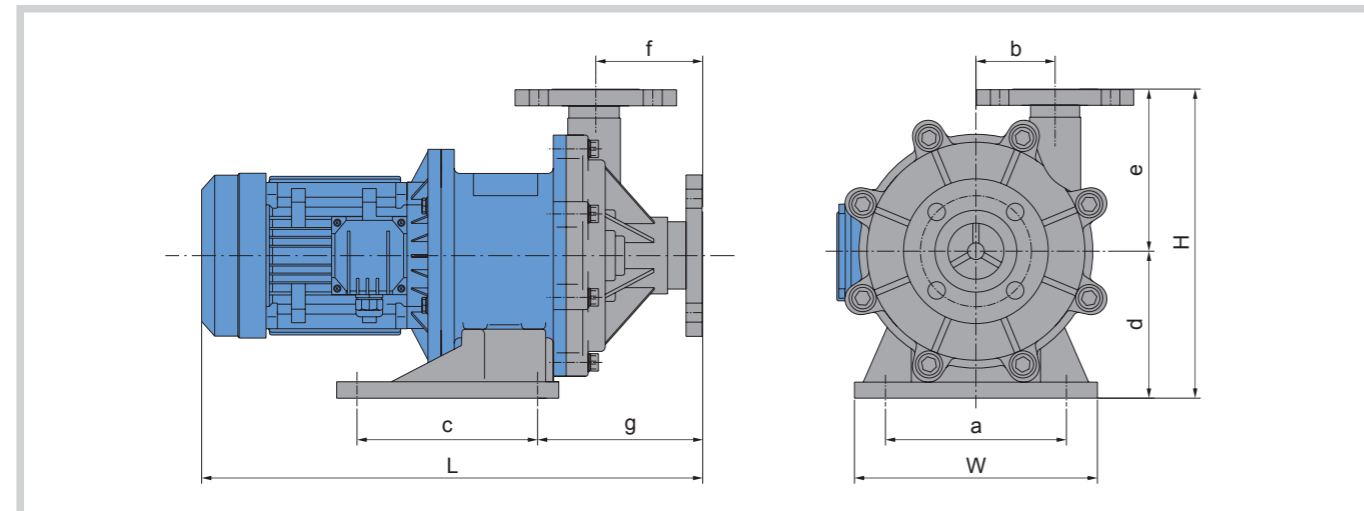

型号 Model	W	H	L	a	b	c	d	e	f	g
MPH-440	140	217	418.5	110	48.5	99	96	121	85.5	135.5
MPH-441	161	255	528	132	55	130.5	116	139	105.5	176
MPH-452	263	255	557	208.5	65	202	116	139	90	155
MPH-453	263	255	557	208.5	65	202	116	139	90	155
MPH-455	264	274.5	620	230	65	265	135.5	139	90	149
MPH-563	264	273	588	210	65	200	115	145	105	170
MPH-565	264	297.5	641.5	230	65	265	135.5	162	111	170.5
MPH-663	263	273	588	210	65	200	115	145	105	170
MPH-665	255	355	626	220	75	300	165	170	100	180
MPH-667	255	355	736	220	75	300	165	170	100	180

MPX 系列磁力驅動循環泵

MPX SERIES MAGNETIC DRIVE CIRCULATING PUMP



MPX-257S(H)



MPX-258S(H)



MPX-251



MPX-453

- MPX系列产品是本公司特别为表面处理工艺研制开发的专业用泵。其设计理念是“耐用、高效”，即在异常的工况条件下不易出现故障而损坏。在经实践验证过的可靠的无接触构造的基础上，采用全新的高效水力模式构造，从而在泵空运转、汽蚀、出口阀关闭等异常工况条件先使用时，泵的耐受性能得到大幅提高。MPX系列磁力泵是可靠的工业用泵。MPX系列磁力泵适用于过滤、喷淋、清洗、蚀刻等等，各种表面处理相关工艺。

- The MPX series is a professional pump developed by our company specially for surface treatment process. Its design concept is "durable and efficient", that is, it's invulnerable to failure and damages in abnormal working conditions. Based on the reliable non-contact structure through practical validation, it adopts a brand-new efficient hydraulic mode for its structure, thus its durability can be improved substantially when used in abnormal working conditions like idle running, cavitation and closing of outlet valve. The MPX magnetic pump is a reliable industrial pump. It's applicable for filtration, spraying, cleaning, etching and other kinds of relevant surface treatment process.

非接觸構造 Non-contact Structure

- 通过精确的磁力驱动位置，可有效对磁囊的位置进行磁力控制，即使在空转时轴承的后端也不会与后止推环接触。这种构造有效的减少了摩擦，降低了由于在异常工况条件下泵的故障率。

- Through the precise magnetic drive position, it can exercise magnetic control over the magnetic capsule's position effectively, and the bearing's rear end will not contact the rear thrust ring even in idle running. Such a structure reduces friction effectively and lowers the pump's failure rate in abnormal working conditions.

型號意義 MODEL EXPLANATION

MPX - F - 44 - 0 - C - C - V - 6 - V38 - A

① ② ③ ④ ⑤ ⑥ ⑦ ⑧ ⑨ ⑩

1. 機型編號 Model

MPX

2. 泵材材質 Material

PP-PP P-PVDF
F-GFRPP E-CFRETPE

3. 出入口徑 In-outlet

25-25×25mm 44-40×40mm
45-40×50mm 56-50×65mm

4. 馬力 Power

0-1/2HP 1-1HP 2-2HP
3-3HP 5-5HP

5. 泵軸材質 Spindle

C-陶瓷 Ceramic S-碳化矽 SIC

6. 軸承材質 Bearing

A-陶瓷 Ceramic P-鐵弗龍 PTFE
C-碳素 Carbon S-碳化矽 SIC

7. 橡膠材質 Rubber

V-VITON E-EPDM P-PFA

8. 頻率 Frequency

5-50Hz 6-60Hz

9. 電壓 Voltage

V38-220V/380V/3Ø
V41-208V/415V/3Ø
V44-240V/440V/3Ø

10. 藥液比重 Specific Weight

50Hz: A-1.2 B-1.5 C-2.0
60Hz: D-1.2 E-1.5 F-2.0

過流端材質 FLOW PASSAGE END MATERIAL

零件名稱 Description	MPX-PP Series			MPX-F Series			MPX-P Series				MPX-E Series
	CC	CP	CA	CC	CP	CA	CC	CP	CA	SS	SS
前蓋 Front Casing	PP			GFRPP			PVDF				CFRETPE
前蓋止推環 Front Thrust Ring				Ceramic							SIC
出入口環 In-outlet O-ring	EPDM / VITON / PFA										
出入口法蘭 In-outlet Flange	PP			CFRPP			PVDF				CFRETPE
叶轮 Impeller	CFRPP										
耐磨圈 Mouth Ring				PTFE							SIC
軸承 Bearing	Carbon	PTFE	Ceramic	Carbon	PTFE	Ceramic	Carbon	PTFE	Ceramic		
被動磁鐵 Magnet Capsule	PP						PVDF				CFRETPE
後蓋 Rear Casing											
軸心 Spindle				Ceramic							SIC
後蓋止推環 Rear Thrust Ring				CFRPPS							
密封環 O-ring	EPDM / VITON / PFA										

技術參數 TECHNICAL PARAMETERS

50HZ

型號 Model	標準尺寸 入口×出口 Inlet×Outlet	叶轮記號 Impeller Mark	比重極限 Specific Gravity	最大流量 Max Flow (L/min)	標準規格 Standard (L/min)	最小流量 Min Flow (L/min)	馬達功率 Power (kW)	重量 Weight (kg)
MPX-257S(H)	G1×G1	-	1.2	90	50-5.4	1	0.15	6.5
MPX-258S(H)	G1×G1	-	1.2	110	70-6	1	0.26	8.2
MPX-250	25×25	5	1.2	150	50-14	10	0.4	13.5
MPX-251	25×25	5	1.0	150	80-19	10	0.75	18.5
MPX-440	40×40	5	1.2	280	100-10.5	10	0.4	13.5
MPX-441	40×40	5	1.2	320	150-14.5	10	0.75	18.5
MPX-452	50×40	5	1.2	450	200-20	20	1.5	30.5
MPX-452H	50×40	5	1.0	160	100-30	20	1.5	30.5
MPX-453	50×40	5	1.2	500	200-23	20	2.2	33
MPX-453H	50×40	5	1.0	300	100-35	20	2.2	33

• MPX-257S(H)、258S(H)有軟管連接。(連接口徑: 26mm)

• MPX-257S(H), 258S(H) provided with hose connection (diameter: 26mm)

性能曲線 PERFORMANCE CURVE

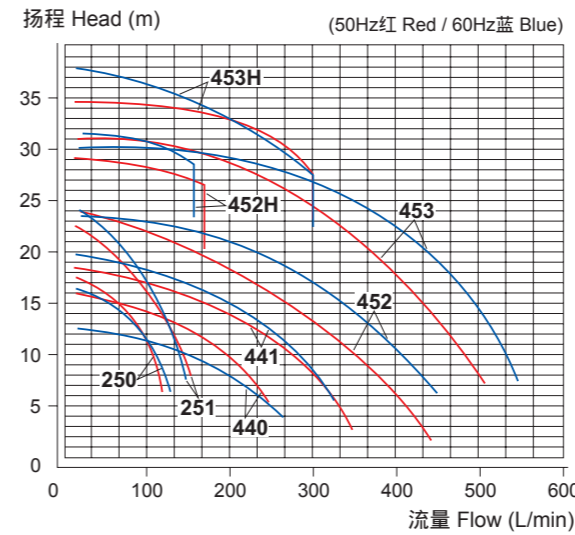

MPX250~MPX453H

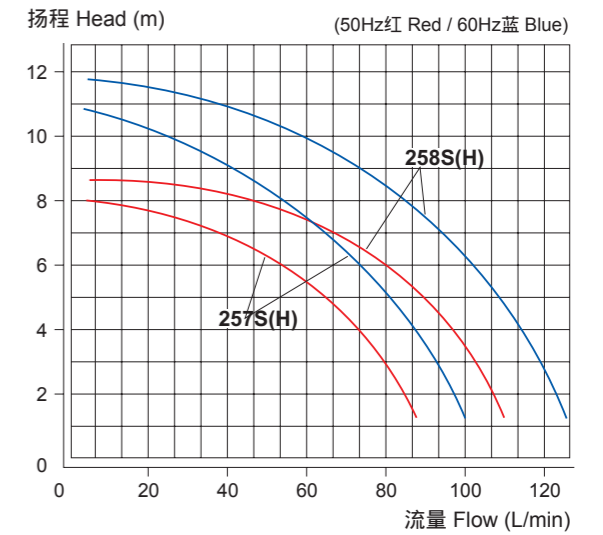

MPX257S(H)~MPX258S(H)

安裝尺寸 INSTALLATION DIMENSIONS

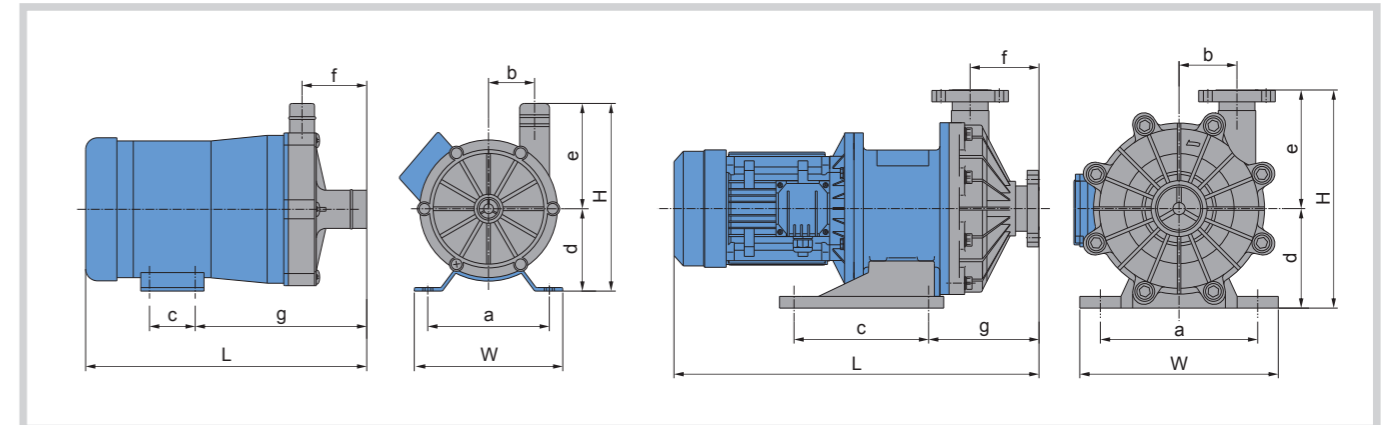

型號 Model	W	H	L	a	b	c	d	e	f	g
MPX-257S(H)	130	155	280.5	110	48	40	65	90	52	158.5
MPX-258S(H)	156	178	334.5	110	52	70	76.5	101.5	63	160.5
MPX-250	160	258	426	129	65	131	117	140	90	154
MPX-251	159.5	255	466	130	65	131	114	140	90	171
MPX-440	140	226.5	426	110	54	99	96	130.5	87.5	149
MPX-441	159.5	255	480	130	71	131	114	140	104.5	185
MPX-452	260	280	513	209.5	80	202.5	120	160	92	150
MPX-453	260	280	513	209.5	80	202.5	120	160	92	150

MP 系列磁力驅動循環泵 MP SERIES MAGNETIC DRIVE CIRCULATING PUMP

性能曲綫 PERFORMANCE CURVE

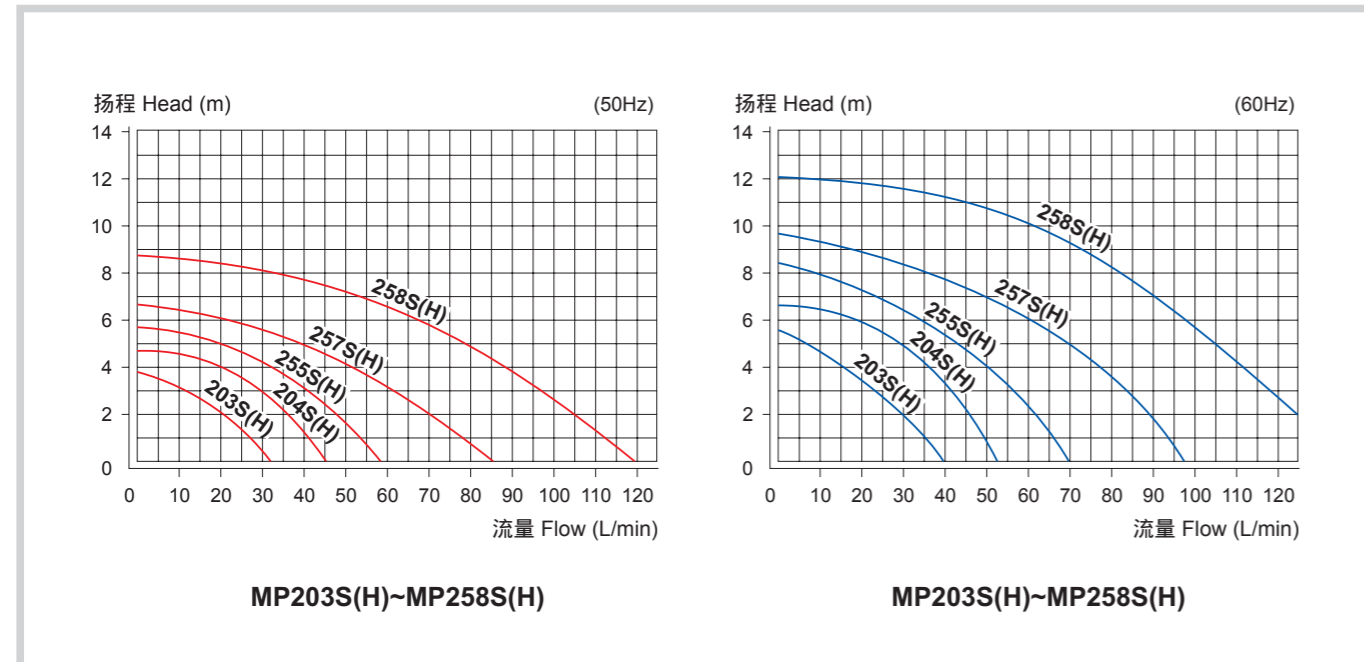

技術參數 TECHNICAL PARAMETERS

型号 Model		MP-203S(H)	MP-204S(H)	MP-255S(H)	MP-257S(H)	MP-258S(H)
比重限制 S.G.		1.3	1.1	1.2	1.0	1.2
套管式口径 Hose Connected	入口 Inlet (mm)	20	20	26	26	26
	出口 Outlet (mm)	20	20	26	26	26
外牙式口径 Screwed	入口 Inlet (inch)	3/4	3/4	1	1	1
	出口 Outlet (inch)	3/4	3/4	1	1	1
全流量 Max Flow	50Hz (L/min)	32	45	60	86	120
	60Hz (L/min)	38	52	70	97	135
全扬程 Max Head	50Hz (m)	3.8	4.6	5.6	6.7	8.6
	60Hz (m)	5.4	6.5	8.2	9.7	11.9
标准输出量 Standard Output	50Hz (M-L/min)	2.5-16	4-22	4-30	4-50	6.5-60
	60Hz (M-L/min)	2.5-24	4-34	4-45	4-72	9-70
马达 Motor 50Hz/60Hz	输出功率 Output (W)	45	65	90	150/180	255/265
	输入功率 Input (W)	60/80	90/130	130/170	210/300	345/365
	相数 Phase (∅)	1	1	1 or 3	1 or 3	1 or 3
重量 Weight		4.0	4.3	5.0	6.3	7.9

型號意義 MODEL EXPLANATION

MP - F - 25 - 8 - S - C - V - 6 - V38

① ② ③ ④ ⑤ ⑥ ⑦ ⑧ ⑨

1. 机型号 Model

MP MPX

2. 泵体材质 Material

PP-PP P-PVDF
F-GFRPP E-CFRETFE

3. 出入口径 In-outlet

20-3/4" 25-1"

4. 马力 Power

3-45W 4-65W 5-90W
7-180W 8-260W

5. 出入连接 Connection

S-牙口 Screw H-软管 Hose

6. 泵轴材质 Spindle

A-陶瓷 Ceramic S-碳化矽 SIC

7. 橡胶材质 Rubber

V-VITON E-EPDM P-PFA

8. 频率 Frequency

5-50Hz 6-60Hz

9. 电压 Voltage

V11-110V/1∅ V22-220V/240V/1∅
V38-220V/380V/3∅
V41-208V/415V/3∅

過流端材質 FLOW PASSAGE END MATERIAL

零件名称 Description	MP-PP Series	MP-F Series	MP-P Series	MP-E Series
前盖 Front Casing	PP	GFRPP	PVDF	CFRETFE
轴承 Bearing	Rulon / CFRPPS		Rulon / SIC	SIC
止推环 Thrust Ring	Ceramic		Ceramic / SIC	
叶轮 Impeller	CFRPP		PVDF	CFRETFE
耐磨圈 Mouth Ring	Rulon			
轴承 Bearing	Rulon / CFRPPS		Rulon / SIC	SIC
轴心 Spindle	Ceramic		Ceramic / SIC	
后盖 Rear Casing	PP	GFRPP	PVDF	CFRETFE
后盖铁圈 Retainer Ring	SUS 304			
密封环 O-ring	EPDM / VITON / PFA			
驱动磁铁 Drive Magnet	Isotropic Ferrite			

安裝尺寸 INSTALLATION DIMENSIONS

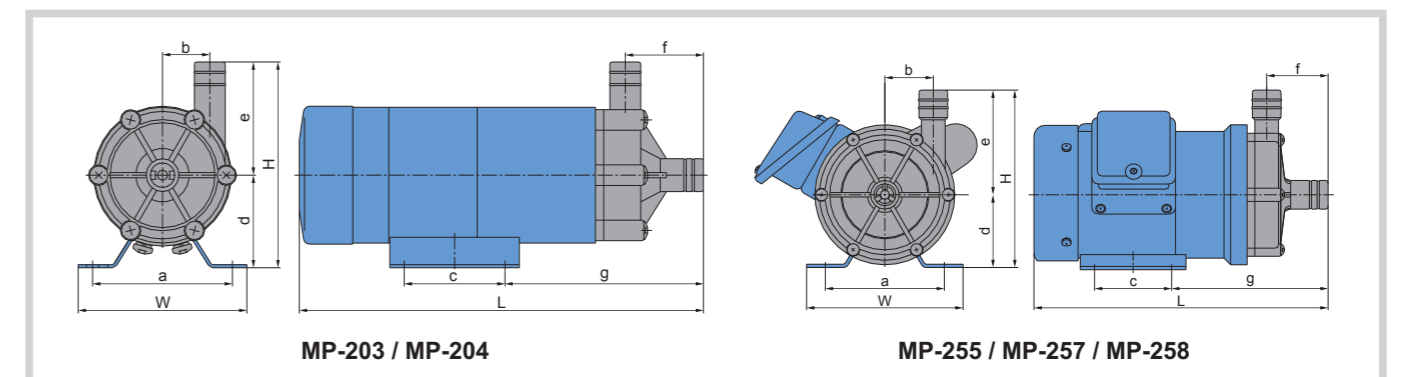

型号 Model	W	H	L	a	b	c	d	e	f	g
MP-203	120	133.5	282	100	31	40	62	71.5	47	148
MP-204	120	133.5	282	100	31	40	62	71.5	47	148
MP-255	120	155	301.5	100	43	40	65	90	62	180
MP-257	130	157	278	110	42	40	68	89	51	155
MP-258	156	170	334	110	43	70	71	99	64.5	163

AMX 系列高壓磁力驅動泵

AMX SERIES HIGH-PRESSURE MAGNETIC DRIVE PUMPS

產品特點

- 由专门之泵浦流体力设计软体计算出最佳流道几何，配合流场分析，掌握流体特性，使流体损失降为最低，提高叶片效率。
- 独具创意的动态式缓冲座，除具备缓冲作用以吸收泵浦叶轮在吸入条件恶劣时之振动外，并提供止推环与叶轮磨损环间一动态式的平面接触，保持摩擦面之有效接触面积，可大幅提高止推环可靠度，降低疲劳损害。
- 新型耐空转设计，自冷却循环回路，可大幅提高空转能力。

FEATURES

- The special pump flow force design software, plus flow field analysis, is used to calculate the optimal flow channel geometry and master fluid characteristics so that the flow loss is minimized and the vane efficiency is higher.
- The unique and creative dynamic buffer seat has a buffer action to absorb vibration produced by the pump impeller in harsh suction conditions, and also can provide a dynamic plane contact between thrust ring and impeller wear ring to keep an effective contact area of friction surface, thus improving the thrust ring's reliability greatly and reducing fatigue and injuries.
- Its brand-new design of idle running resistance and self-cooling circulating loop improve its idle running capacity substantially.



AMX-441



AMX-542

技術參數 TECHNICAL PARAMETERS

型号 Model	口径 Diameter (mm)		流量 Flow (L/min)		扬程 Head (m)		马力 Power (kW)	极数 Poles	使用液体 温度范围 Temperature
	入口 Inlet	出口 Outlet	50HZ	60HZ	50HZ	60HZ			
AMX-440	40	40	100	100	10.9	11.3	0.4	2	5~80℃
AMX-441	40	40	150	150	16	15.4	0.75	2	5~80℃
AMX-542	50	40	200	200	20.6	20.3	1.5	2	5~80℃
AMX-552	50	50			25.8	28.6			
AMX-542H	50	40	100	100	25.8	28.6	1.5	2	5~80℃
AMX-552H	50	50							
AMX-543	50	40	250	250	25.8	26.2	2.2	2	5~80℃
AMX-553	50	50							
AMX-543H	50	40	150	150	31.8	33.7	2.2	2	5~80℃
AMX-553H	50	50							
AMX-545	50	40	250	250	30.2	35.4	3.75	2	5~80℃
AMX-555	50	50							
AMX-653	65	50	500	500	16.6	16.4	2.2	2	5~80℃
AMX-655	65	50	500	500	25.4	25.2	3.75	2	5~80℃

性能曲線 PERFORMANCE CURVE

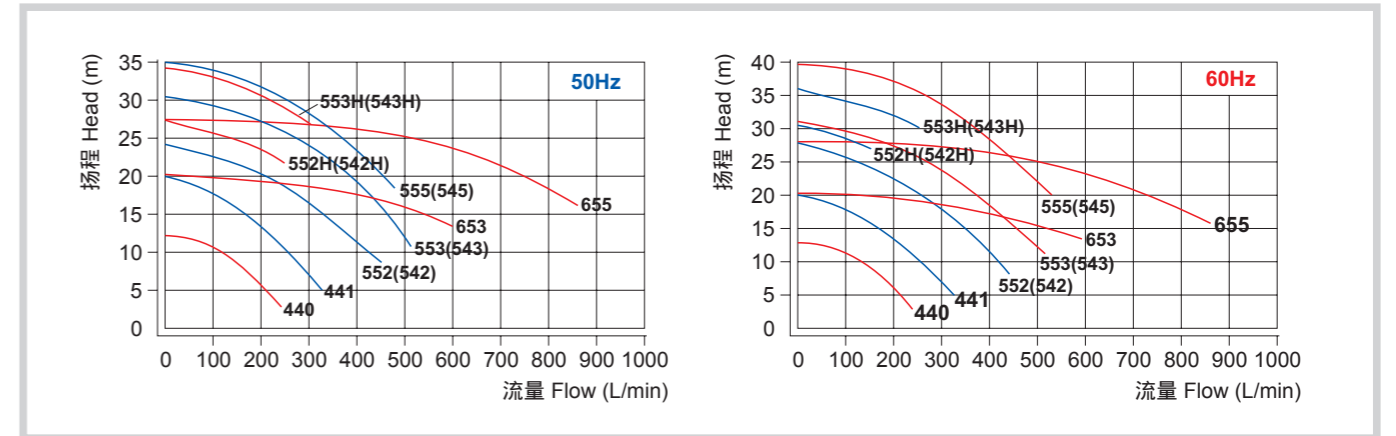

安裝尺寸 INSTALLATION DIMENSIONS

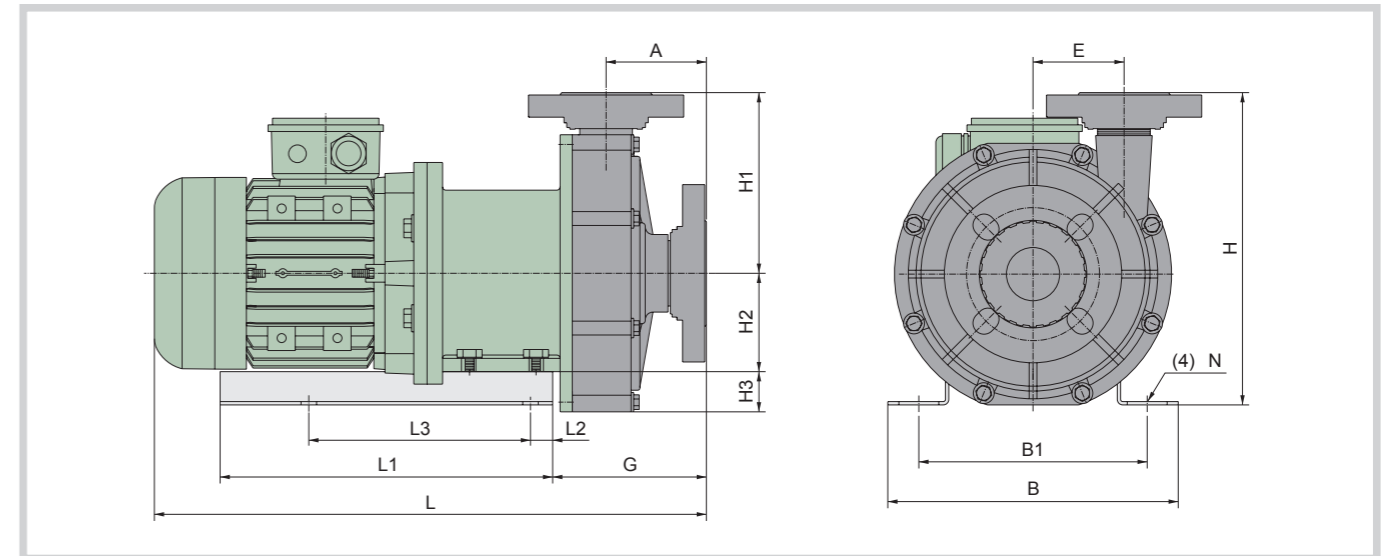

型号 Model	尺寸 Dimensions (mm)													
	A	B	B1	E	G	H	H1	H2	H3	L	L1	L2	L3	N
AMX-440	87.5	140	110	54	130.5	225.5	130.5	75	20	443	200	20	98	12
AMX-441	105.5	160	130	72	151.5	257.5	142.5	85	30	490	210	35	130	12
AMX-542(H)	91	260	204	80	139	282.5	162.5	90	30	499	300	20	200	14
AMX-552(H)	91	260	204	80	139	281.5	162.5	90	30	499	300	20	200	14
AMX-543(H)	91	260	204	80	139	282.5	162.5	90	30	525	300	20	200	14
AMX-553(H)	91	260	204	80	139	281.5	162.5	90	30	525	300	20	200	14
AMX-653	92	250	220	80	126	331	169	132	30	532	360	30	300	14
AMX-545	91	250	220	80	117	324.5	162.5	132	30	593	360	30	300	14
AMX-555	91	250	220	80	117	323.5	161.5	132	30	593	360	30	300	14
AMX-655	92	250	220	80	123	331	169	132	30	600	360	30	300	14

MPM 系列氟塑料磁力驅動泵

MPM SERIES FLUOROPLASTIC MAGNETIC DRIVE PUMP

- MPM系列磁力泵的过流部件均有高氟烷乙醚(PFA)和乙烯聚四氟乙烯(ETFE)制成,采用独特的机械构造加固泵体,有足够的强度承受管道以及外界的机械冲击,广泛应用于半导体工业中高纯度化学液体以及各类酸碱的流程输送,为了检修方便,该泵采用后接式结构,不需要拆卸管道,一个人便可进行内部配件的检修及更换。
- All flow passage parts of the MPM series magnetic pump are made of PFA and ETFE. The pump is reinforced with a unique mechanical structure to be strong enough to bear the pipeline and external mechanical shock. It's widely applied for process transportation of highly chemical liquids, acid and alkali in the semiconductor industry. To facilitate overhaul, it adopts a rear connection structure so that one person can conduct overhaul and replacement of internal parts without disassembling the pipeline.



MPM40 (ETFE)

MPM25 (PFA)

技術參數 TECHNICAL PARAMETERS

2 Pole Motor Type

型号 Model	进出口径 In-outlet (mm)	50HZ			60HZ			功率 Power (kW)
		叶轮大小 Impeller Size	流量 Flow (L/min)	扬程 Head (m)	叶轮大小 Impeller Size	流量 Flow (L/min)	扬程 Head (m)	
MPM25-1	40×25	165	100	35.5	140	100	36	1.5 or 2.2
		160		34			29.5	
		150		29			25	
		140		25			20.5	
		130		21			15	
MPM25-2	40×25	195	100	50.5	170	100	54.5	3.7, 5.5 or 7.5
		190		49			48.5	
		180		44.5			41	
		170		38			36.5	
		160		34.5			30.5	
MPM40-1	50×40	165	208	35	145	250	38	3.7, 5.5 or 7.5
		160		32.5			35.5	
		150		29			29	
		140		25.5			25	
		130		21.5			19.5	
MPM50-1	65×50	120	417	17.5	110	500	—	3.7, 5.5 or 7.5
		165		33			44.5	
		160		32			39	
		150		28			33	
		140		23.5			27	
MPM65-1	80×65	130	833	18	120	1000	21.5	5.5, 7.5, 11 or 15(60Hz only)
		120		15			18	
		110		11			—	
		165		39			51	
		160		35.5			43.5	
		150		31	140		36.5	
		140		26			31.5	
		130		21.5			25.5	
		120		17			20	
		110		13.5			—	

4 Pole Motor Type

型号 Model	进出口径 In-outlet (mm)	50HZ			60HZ			功率 Power (kW)
		叶轮大小 Impeller Size	流量 Flow (L/min)	扬程 Head (m)	叶轮大小 Impeller Size	流量 Flow (L/min)	扬程 Head (m)	
MPM25-2	40×25	200	50	12	200	50	18.5	1.5, 2.2, 3.7
MPM40-1	50×40	170	200	7.5	170	200	11.5	1.5, 2.2, 3.7
MPM50-1	65×50	170	300	7	170	300	11.5	1.5, 2.2, 3.7
MPM65-1	80×65	170	500	8	170	500	13	1.5, 2.2, 3.7, 5.5

KPH 系列可空轉直立式耐酸碱泵

KPH SERIES IDLE RUNNING RESISTANT VERTICAL ACID AND ALKALI RESISTANT PUMP

產品特點

- 泵体采用CPVC、PP、PVDF工程塑料射出成型,耐腐蚀,适用于各种酸碱液输送、循环、蚀刻机清洗、废水处理、电镀涂装等。
- 可空转运行,绝不因空转而损坏。
- 出口为万能接头设计,用户可按需求接PP、PVC、PVDF等不同材质的管,方便安装、维修保养。
- 进水口过滤网设计,防止杂物进入损坏水叶或导致马达烧坏。
- 本泵浦马达采用环氧树脂防腐涂层,不易生锈。防护等级为IP55及F级绝缘。

FEATURES

- The pump body adopts CPVC, PP and PVDF engineering plastics with injection moulding and corrosion resistance, which is applicable for transportation and circulation of different kinds of acid and alkali, spraying of etching machines, waste water treatment, electroplating coating, etc.
- It's available for idle running and 100% invulnerable to damages due to idle running.
- Its outlet adopts universal joint design. The user can connect pipes made of different materials like PP, PVC and PVDF as required, easy for installation, repair and maintenance.
- Its water inlet adopts filter screen design to prevent impurities from entering to damage the water ring or burn out the motor.
- This pump's motor adopts epoxy anti-corrosion coating, invulnerable to rust. Its protection class is IP55 and F insulation.



KPH-1/8HP(PVDF)

KPH-1/2HP

KPH-1HP

KPH-2HP

型號意義 MODEL EXPLANATION

KPH168 - 0.75 - 400 - PP

① ② ③ ④

1. 机型编号 Model

KPH85 KPH90 KPH115 KPH168

2. 马力 Power

0.05-1/15HP 0.09-1/8HP 0.12-1/6HP 0.18-1/4HP
0.25-1/3HP 0.37-1/2HP 0.55-3/4HP 0.75-1HP
1.10-1-1/2HP 1.50-2HP 2.20-3HP

3. 液下深度 Submerged Depth

220 230 320 400

4. 泵体材质 Material

PP CPVC PVDF

性能曲綫 PERFORMANCE CURVE

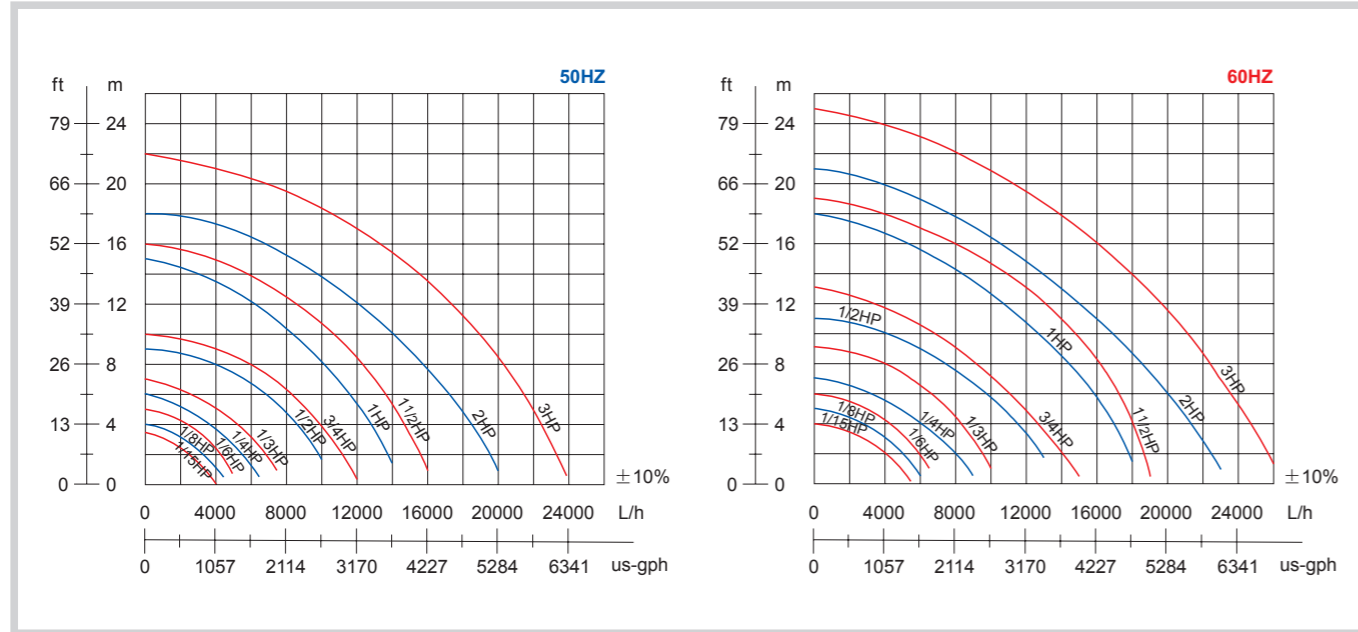

技術參數 TECHNICAL PARAMETERS

型号 Model	进出口径 In-outlet (mm)		最大流量 Max Flow (L/h)		最高扬程 Max Head (m)		马达 Motor					包装尺寸 Packing Size			
	进口 Inlet (mm)	出口 Outlet (mm)	50Hz	60Hz	50Hz	60Hz	马力 Power (HP)	转速 Speed (r/min)	伏特 (V)	相数 Phase (PH)	安培 (A)	长 L (mm)	宽 W (mm)	高 H (mm)	净重 Weight (kg)
KPH168-2.20-400PP/PVDF	50	40	24000	26000	22	25	3	2800/3400	380/220	3	4.7/8.1	740	320	320	24.7
KPH168-1.50-400-PP/PVDF	50	40	20000	23000	18	21	2	2800/3400	380/220	3	3.4/5.9	740	320	320	23.8
KPH168-1.10-400-PP/PVDF	50	40	16000	19000	16	19	1-1/2	2800/3400	380/220	3	2.5/4.4	740	320	320	20.5
KPH168-0.75-400-PP/PVDF	50	40	14000	18000	15	18	1	2800/3400	380/220	3	1.8/3.1	740	320	320	19.5
KPH168-0.55-400-PP/PVDF	50	40	12000	15000	10	13	3/4	2800/3400	380/220	3	1.35/2.4	740	320	320	19.4
KPH115-0.37-320-PP/PVDF	40	25	10000	13000	9	11	1/2	2800/3400	380/220	3	1.0/1.75	550	250	250	12.2
	40	25	10000	13000	9	11	1/2	2800/3400	220-240	1	2.6	560	250	250	12.2
KPH90-0.25-230-PP/PVDF	40	25	7500	10000	7	9	1/3	2800/3400	380/220	3	0.53/0.92	440	210	160	7.3
	40	25	7500	10000	7	9	1/3	2800/3400	220-240	1	1.55	440	210	160	7.3
KPH90-0.18-230-PP/PVDF	40	25	6500	9000	6	7	1/4	2800/3400	380/220	3	0.68/1.18	440	210	160	6.7
	40	25	6500	9000	6	7	1/4	2800/3400	220-240	1	1.29	440	210	160	6.7
KPH85-0.12-220-PP/PVDF	32	20	5000	6500	5	6	1/6	2800/3400	220-240	1	1.0	440	210	160	5.7
KPH85-0.09-220-PP/PVDF	32	20	4500	6500	4	5	1/8	2800/3400	220-240	1	0.7	440	210	160	5.2
KPH85-0.05-220-PP/PVDF	32	20	4500	5500	3.5	4	1/15	2800/3400	220-240	1	0.5	440	210	160	4.8

安裝尺寸 INSTALLATION DIMENSIONS

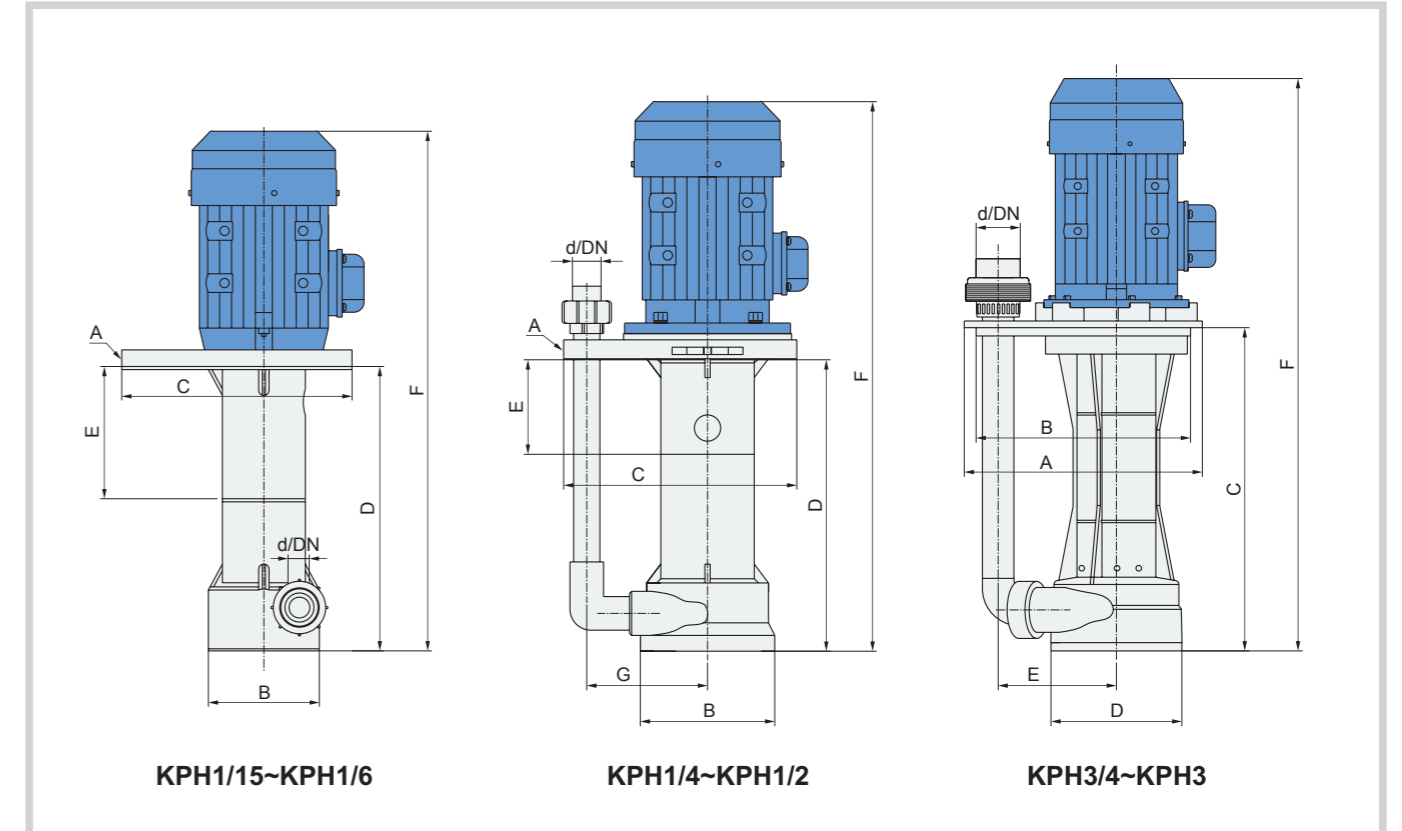

型号 Model	口径 Diameter	相数 Phase	尺寸 Dimensions (mm)					
			A	B	C	D	E	F
KPH85-0.05-220-PP/PVDF	20	1	111	85	170	218	100	400
KPH85-0.09-220-PP/PVDF	20	1	111	85	170	218	100	400
KPH85-0.12-220-PP/PVDF	20	1	111	85	170	218	100	400
KPH90-0.18-230-PP/PVDF	25	1	170	113	213	282	90	495
KPH90-0.18-230-PP/PVDF	25	3	170	113	213	282	90	495
KPH90-0.25-230-PP/PVDF	25	1	170	113	213	282	90	495
KPH90-0.25-230-PP/PVDF	25	3	170	113	213	282	90	495
KPH115-0.37-320-PP/PVDF	25/32	1	170	113	213	282	90	495
KPH115-0.37-320-PP/PVDF	25/32	3	170	113	213	282	90	495
KPH168-0.55-400-PP/PVDF	25/32	3	300	270	410	168	146	680
KPH168-0.75-400-PP/PVDF	32/40	3	300	270	410	168	146	680
KPH168-1.10-400-PP/PVDF	32/40	3	300	270	410	168	146	680
KPH168-1.50-400-PP/PVDF	32/40	3	300	270	410	168	146	720
KPH168-2.20-400PP/PVDF	32/40	3	300	270	410	168	146	720

KDV 系列高壓可空轉直立式耐酸碱泵 KDV SERIES HIGH-PRESSURE IDLE RUNNING RESISTANT VERTICAL ACID AND ALKALI RESISTANT PUMP



KDV-5HP

KDV-7.5HP

產品特點

- 泵体采用FRPP、PVDF等塑钢材料射出成型。
- 适合于槽内外使用。
- 高效率、低噪音、不泄漏、易于维护。
- 泵浦内使用干式轴封，空转不会损坏，马达端盖有油封设计，确保酸性气体不会进入马达轴承，从而保护马达，增加马达使用寿命。
- 泵浦转动轴可使用SUS304、SUS316L及钛金材质，满足客户使用到不同的工作场所。

FEATURES

- The pump body adopts plastic steel like FRPP and PVDF with injection moulding.
- It's applicable for internal and external use of baths.
- It's efficient, low-noise, zero-leakage and easy for maintenance.
- The pump inside adopts dry shaft seal, invulnerable to damages in idle running. The motor end cover is designed with oil seal to prevent acid gases from entering the motor bearing, thus protecting the motor and extending its service life.
- The pump's rotating shaft can use SUS304 and Ti to meet needs for different applications of customers.

型號意義 MODEL EXPLANATION

KDV - 40 SK 3 6 V F
① ② ③ ④ ⑤ ⑥ ⑦

1. 机型编号 Model

KDV SERIES

3. 比重 Specific Gravity

SK-1.1 SP-1.4

5. 频率 Frequency

5-50Hz 6-60Hz

2. 口径 Diameter

32-1-1/4" 40-1-1/2"
50-2" 100-4"

4. 马力 Power

1-1HP 2-2HP 3-3HP
4-4HP 5-5HP 7.5-7.5HP
11-11HP 15-15HP

6. O环 Ring

V-VITON E-EPT N-NBR

7. 泵体材质 Material

F-FRPP P-PVDF



KDV-3HP

KDV-2HP

KDV-1HP

安裝尺寸圖 INSTALLATION DIMENSIONS

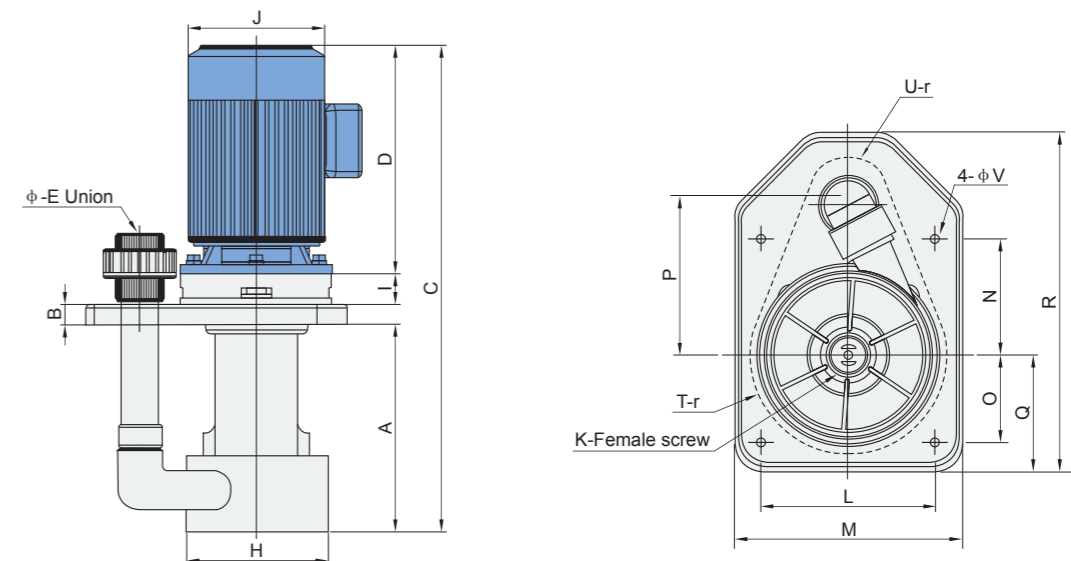

型号 Model	A	B	C	D	E	H	I	J	K	L	M	N	O	P	Q	R	T	U	V
KDV-40SK-15	293	25	648	290	32	187	40	165	50	180	240	90	90	165	120	350	105	40	12
KDV-40SK-25	293	25	667	309	40	187	40	195	50	180	240	90	90	165	120	350	105	40	12
KDV-40SK-35	293	25	667	309	40	187	40	195	50	180	240	90	90	165	120	350	105	40	12
KDV-40SK-45	296	25	706	345	40	187	40	195	50	200	270	100	100	193	135	390	105	40	12
KDV-40SK-55	296	25	706	345	40	187	40	220	50	200	270	100	100	193	135	390	105	40	12
KDV-50SK-7.55	312	35	786	365	50	249	54	260	65	280	342	160	140	231	170	472	135	45	12
KDV-50SK-105	312	35	786	365	50	249	54	260	65	280	342	160	140	231	170	472	135	45	12
KDV-100SK-155	415	40	885	430	100	270	15	260	100	283	375	175	130	300	185	590	140	52	12
KDV-100SK-205	415	40	885	430	100	270	15	260	100	283	375	175	130	300	185	590	140	52	12

性能曲线 PERFORMANCE CURVE

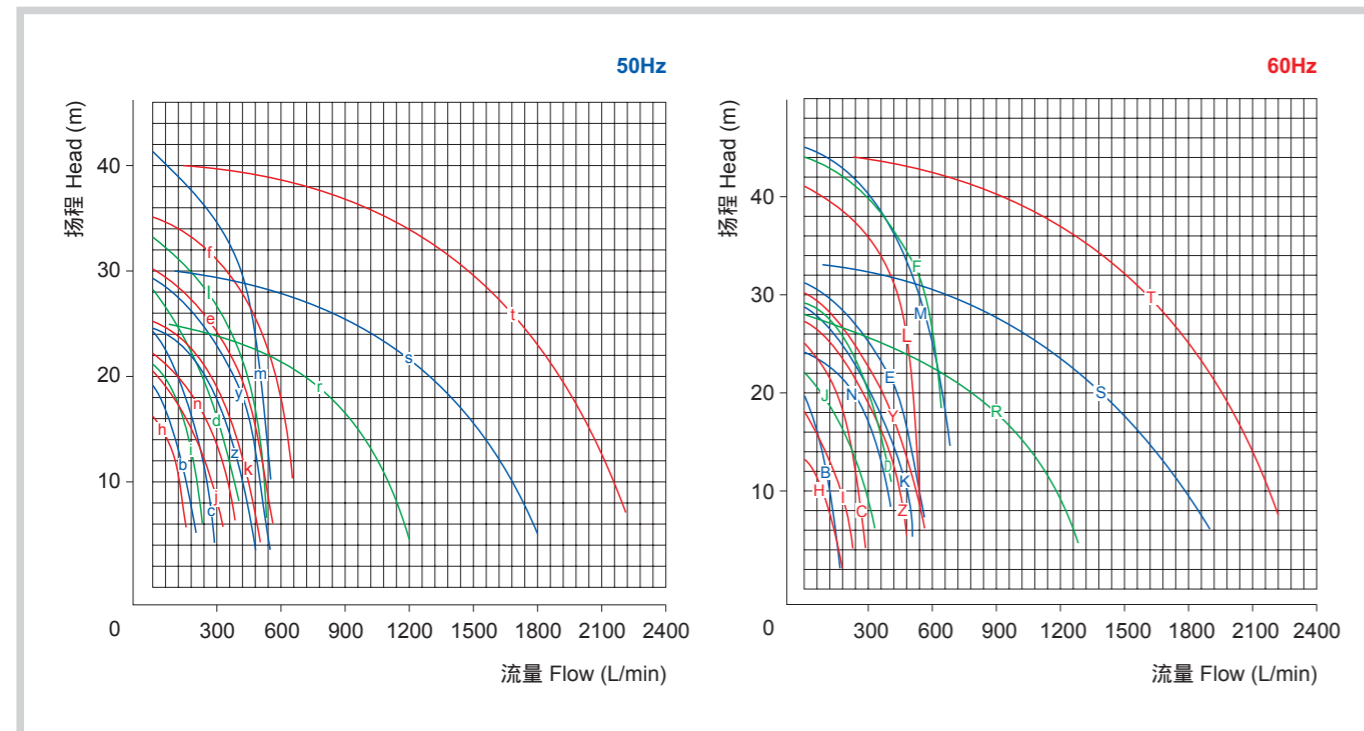

技术参数 TECHNICAL PARAMETERS

型号 Model	比重 Specific Gravity	入口×出口 Inlet×Outlet (mm)	功率 Power		50HZ			60HZ			重量 Weight (kg)
			HP	极数 Poles	曲线 NO	扬程 Head (m)	流量 Flow (L/min)	曲线 NO	扬程 Head (m)	流量 Flow (L/min)	
KDV-32SK-1	1.1	50×25	1	2	b	19	200	B	19.5	160	20
KDV-32SK-2	1.1	50×25	2	2	c	24	290	C	25	290	25
KDV-40SK-2	1.1	50×32	2	2	n	22	380	N	24	400	25
KDV-40SK-3	1.1	50×32	3	2	d	28	400	D	29	400	29
KDV-40SK-4	1.1	65×40	4	2	y	29	450	Y	29	450	32
KDV-50SK-5	1.1	65×40	5	2	e	30	560	E	30	560	46
KDV-50SK-7.5	1.1	65×50	7.5	2	f	35	650	F	44	640	73
KDV-100SK-105	1.1	100×100	7.5	2	r	25	1200	R	28	1280	85
KDV-100SK-155	1.1	100×100	11	2	s	30	1800	S	33	1900	120
KDV-100SK-205	1.1	100×100	15	2	t	40	2250	T	44	2320	130
KDV-32SP-1	1.4	50×25	1	2	h	16	150	H	13	180	20
KDV-32SP-2	1.4	50×25	2	2	i	21	230	I	18	220	25
KDV-40SP-3	1.4	50×32	3	2	j	20	320	J	22	330	29
KDV-40SP-4	1.4	65×40	4	2	z	23	400	Z	25	420	32
KDV-50SP-5	1.4	65×40	5	2	k	25	500	K	28.5	500	46
KDV-50SP-7.5	1.4	65×50	7.5	2	l	33	530	L	41	540	73

KDS 系列不銹鋼直立式耐酸碱泵

KDS STAINLESS STEEL VERTICAL ACID AND ALKALI RESISTANT PUMP

产品特点

- 采用不锈钢316精密铸造成型，无砂孔问题，叶轮效率高。
- 适合各种酸碱液、微酸液，循环使用，耐高温。
- 无轴封设计，绝不因空运转而损坏，设计有防止酸气进入轴承之密封圈，及溢流导沟。
- 叶轮经动力平衡校正，低噪音，低振动。
- 泵体积小，适合槽内槽外设计使用。

FEATURES

- It adopts stainless steel 316 with precision casting and forming, no sand hole and high efficiency of impeller.
- It's applicable for different kinds of acid and alkali liquids plus slightly acid liquids, with circulating use and resistance to high temperature.
- With glandless design, it's 100% invulnerable to damages caused by idle running. Also it's designed with a gasket ring preventing acid gases from entering the bearing as well as an overflowing guide channel.
- The impeller is calibrated with dynamic equilibrium, thus featured by low noise and small vibration.
- The pump is compact and thus suitable for both internal and external design and use of baths.



KDS-40SK-1

KDS-50SK-5

型号意义 MODEL EXPLANATION

KDS - 25 SK - 1/2 6 N S I S

① ② ③ ④ ⑤ ⑥ ⑦ ⑧ ⑨

1. 机型编号 Model

KDS-不锈钢 Stainless Steel 316#
KDT-钛金属 Titanium Metal

2. 口径 Diameter

25-1" 40-1-1/2" 50-2"
65-2-1/2" 80-3"

3. 比重 Specific Gravity

SK-1.1 SP-1.4 SL-低转速4P

4. 马力 Power

1/2-1/2HP 1-1HP 2-2HP 3-3HP
5-5HP 7-7.5HP 10-10HP

5. 频率 Frequency

5-50Hz 6-60Hz

6. O环 Ring

N-NBR E-EPDM
V-VITON T-TEFLON

7. 泵体材质 Material

S-SUS 316 T-钛 Titanium

8. 安装型式 Installation

I-槽内安装 Internal
S-槽外安装 External

9. 标准/特殊 Standard/Special

S-特殊规格 Special Specifications
N-标准机型 Standard Model

性能曲綫 PERFORMANCE CURVE

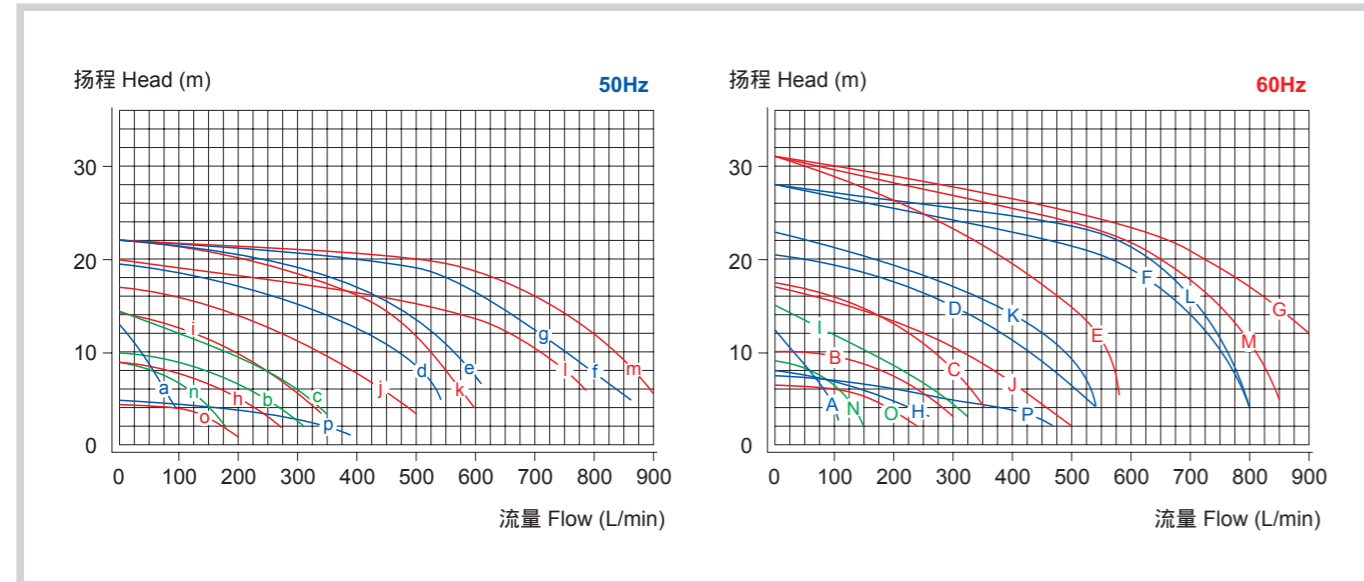

技術參數 TECHNICAL PARAMETERS

型号 Model	比重 Specific Gravity	进出口径 In-outlet (mm)	马力 Power			50HZ			60HZ			重量 Weight (kg)
			相数 Phase	HP	极数 Poles	曲线 NO	扬程 Head (m)	流量 Flow (L/min)	曲线 NO	扬程 Head (m)	流量 Flow (L/min)	
KDS-25SK-1/2	1.1	1"×1"	1, 3	1/2	2	a	13	95	A	12.5	105	26
KDS-40SK-1	1.1	1 1/2"×1 1/2"	1, 3	1	2	b	10	310	B	10	300	29
KDS-40SK-2	1.1	1 1/2"×1 1/2"	3	2	2	c	14.5	350	C	17.5	350	32
KDS-50SK-3	1.1	2"×2"	3	3	2	d	19.5	540	D	20.5	540	56
KDS-50SK-5	1.1	2"×2"	3	5	2	e	22	600	E	31	580	72
KDS-65SK-7.5	1.1	3"×2 1/2"	3	7.5	2	f	22	860	F	28	800	116
KDS-65SK-10	1.1	3"×2 1/2"	3	10	2	g	22	860	G	31	1050	122
KDS-40SP-1	1.4	1 1/2"×1 1/2"	1, 3	1	2	h	9	280	H	8	260	29
KDS-40SP-2	1.4	1 1/2"×1 1/2"	3	2	2	i	14.5	340	I	15	325	32
KDS-50SP-3	1.4	2"×2"	3	3	2	j	17	500	J	17	500	54
KDS-50SP-5	1.4	2"×2"	3	5	2	k	22	600	K	23	540	72
KDS-65SP-7.5	1.4	3"×2 1/2"	3	7.5	2	l	20	760	L	28	800	116
KDS-65SP-10	1.4	3"×2 1/2"	3	10	2	m	22	920	M	31	850	122
KDS-40SL-1/2	1.4	1 1/2"×1 1/2"	3	1/2	4	o	4.5	195	O	6.5	240	29
KDS-50SL-1	1.4	2"×2"	3	1	4	p	5	390	P	7.5	470	45
KDT-40SK-1/2	1.1	1 1/2"×1 1/2"	1, 3	1/2	2	n	9	180	N	9	150	24
KDT-40SK-1	1.1	1 1/2"×1 1/2"	1, 3	1	2	b	10	310	B	10	300	27
KDT-40SK-2	1.1	1 1/2"×1 1/2"	3	2	2	c	14.5	350	C	17.5	350	30

安裝尺寸 INSTALLATION DIMENSIONS

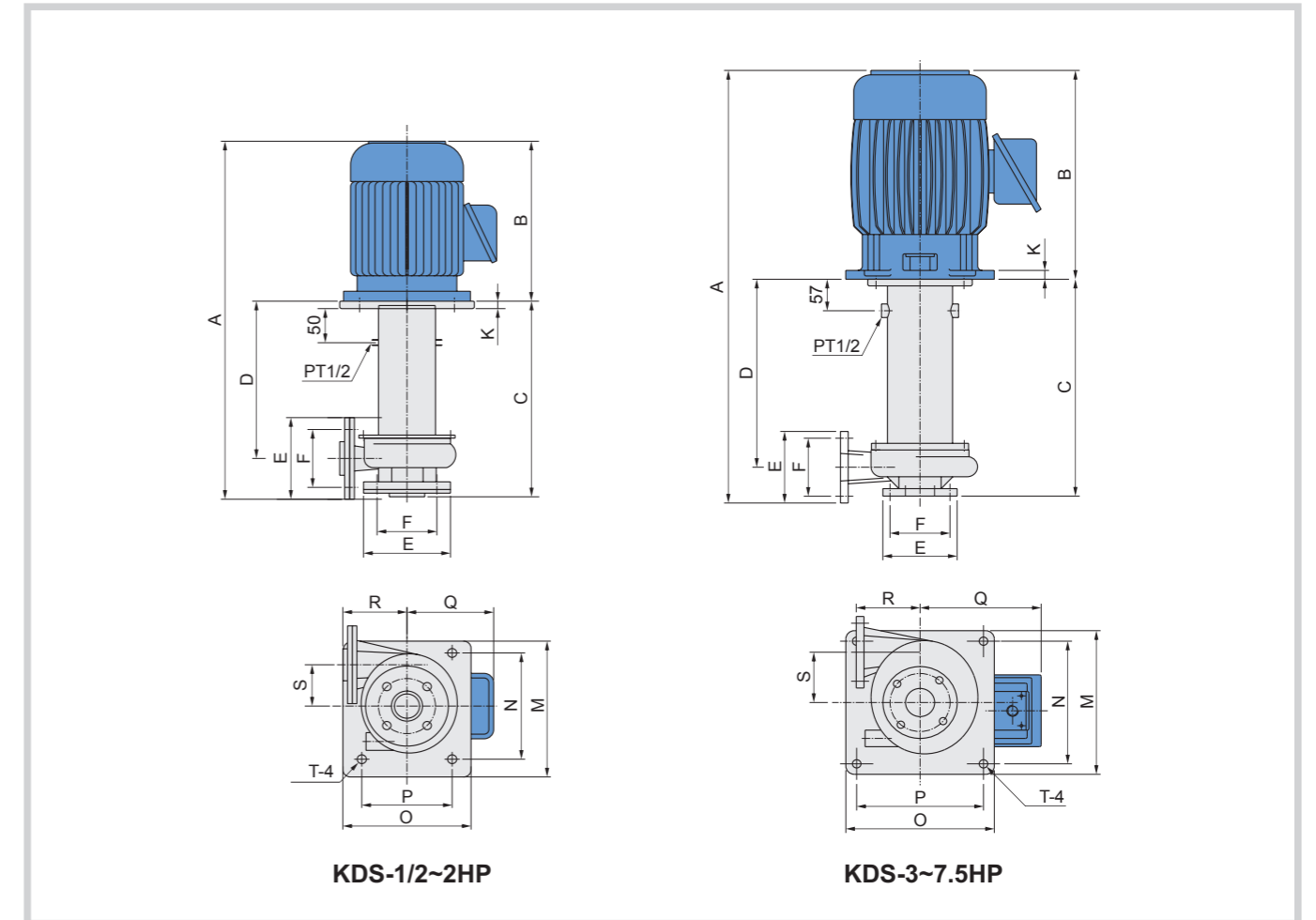

型号 Model	A	B	C	D	E	F	K	M	N	O	P	Q	R	S	T
KDS-25SK/SP-1/2	542	242	300	235	78	64	2	230	80	20	148	142	117	60	5
KDS-40SK/SP-1	552	242	310	247	8	92	2	230	80	20	148	142	135	73	5
KDS-40SK/SP/KDT-2	585	275	310	247	8	92	2	230	80	20	148	142	135	73	5
KDS-50SK/SP-3	733	340	393	340	130	103	16	260	222	260	222	92	133	90	5
KDS-50SK/SP-5	773	380	393	340	130	103	16	260	222	260	222	22	133	90	5
KDS-65SK/SP-7.5	856	440	416	343	175	127	20	350	300	350	300	250	161	95	5
KDS-65SK/SP-10	856	440	416	343	175	127	20	350	300	350	300	250	161	95	5
KDS-40SK-1/2	552	242	310	247	8	92	2	230	80	20	148	142	135	73	5
KDS-40SL-1/2	552	242	310	247	8	92	2	230	80	20	148	142	135	73	5
KDS-50SL-1	688	295	393	343	130	103	16	260	222	260	222	167	133	90	5
KDT-40SK-1/2	552	242	310	247	8	92	2	230	80	20	148	142	135	73	5
KDT-40SK-1/40SK-2	585	275	310	247	8	92	2	230	80	20	148	142	135	73	5

KD 系列可空轉直立式耐酸碱泵

RD SERIES IDLE RUNNING RESISTANT VERTICAL ACID AND ALKALI RESISTANT PUMP

產品特點

- 采用FRPP, CPVC, PVDF各种塑钢材料射出成型可抵抗大部分的化学性, 耐酸、耐碱。
- 适合各种酸碱液循环, 冷却, 喷洗设备, 废气塔、蚀刻机、废水处理等使用。
- 可空运转使用, 绝不因空运转而损坏。
- 有干式轴封设计, 可保护马达防止酸气进入损坏轴承。
- 适合无电解镍化学铜及各种特殊电镀液之循环输送。
- 可配合过滤器连接使用。

FEATURES

- It adopts different kinds of plastic steel, such as FRPP, CPVC and PVDF, with injection moulding, resistant to a majority of chemicals, acid and alkali.
- It's applicable for circulation and cooling of acid and alkali liquids, spraying equipment, waste gas towers, etching machines, waste water treatment and so on.
- It's available for idle running and 100% invulnerable to damages due to idle running.
- Designed with dry shaft seal, it can protect the motor by means of preventing acid gases from entering and damaging the bearing.
- It's applicable for circulating transportation of electroless nickel plating chemical copper and other kinds of special electroplating solutions.
- It can be connected to a filter to work with



KD-50SK-5



KD-65SK-7.5

型號意義 MODEL EXPLANATION

KD - 50 SK 5 6 V F
① ② ③ ④ ⑤ ⑥ ⑦

1. 机型编号 Model

KD SERIES

2. 口径 Diameter

40-1-1/2" 50-2" 65-2-1/2"

3. 比重 Specific Gravity

SK-1.1 SP-1.4

4. 马力 Power

1-1HP 2-2HP 3-3HP
5-5HP 7.5-7.5HP 10-10HP

5. 频率 Frequency

5-50Hz 6-60Hz

6. O环 Ring

V-VITON E-EPT N-NBR

7. 泵体材质 Material

F-FRPP P-PVDF C-CPVC

技術參數 TECHNICAL PARAMETERS

(测试流体: 水, 比重: 1.0 Testing Fluid: Water, Specific Gravity 1.0)

型号 Model	比重 Specific Gravity	进出口径 In-outlet (mm)	马力 Power			50HZ			60HZ			重量 Weight (kg)
			相数 Phase	HP	极数 Poles	曲线 NO	扬程 Head (m)	流量 Flow (L/min)	曲线 NO	扬程 Head (m)	流量 Flow (L/min)	
KD-40SK-1	1.1	50×40	3	1	2	a	14	280	A	13	250	29
KD-40SK-2	1.1	50×40	3	2	2	b	18	400	B	22	320	38
KD-40SK-3	1.1	50×40	3	3	2	c	22	450	C	26	420	41
KD-50SK-3	1.1	65×50	3	3	2	d	21	530	D	23	520	41
KD-50SK-5	1.1	65×50	3	5	2	e	31	580	E	36	560	55
KD-65SK-5	1.1	80×65	3	5	2	f	29	550	F	29	700	55
KD-65SK-7.5	1.1	80×65	3	7.5	2	g	32	780	G	36	560	55
KD-65SK-10	1.1	80×65	3	10	2	g	32	780	H	39.5	1100	106
KD-100SK-15	1.1	100×100	3	15	2	r	36	1660	R	40	1800	123
KD-100SK-20	1.1	100×100	3	20	2	y	40	1750	Y	44	1900	133
KD-40SP-3	1.4	50×40	3	3	2	i	22	400	I	19	340	41
KD-50SP-3	1.4	65×50	3	3	2	j	19	500	J	32	400	41
KD-50SP-5	1.4	65×50	3	5	2	k	19	560	K	32	500	55
KD-65SP-5	1.4	80×65	3	5	2	l	28	520	L	25	600	55
KD-65SP-7.5	1.4	80×65	3	7.5	2	m	31	750	M	35	750	95
KD-65SP-10	1.4	80×65	3	10	2	m	31	750	N	38	850	106
KD-100SP-15	1.4	100×100	3	15	2	t	34	1100	T	38	1300	123

安裝尺寸 INSTALLATION DIMENSIONS

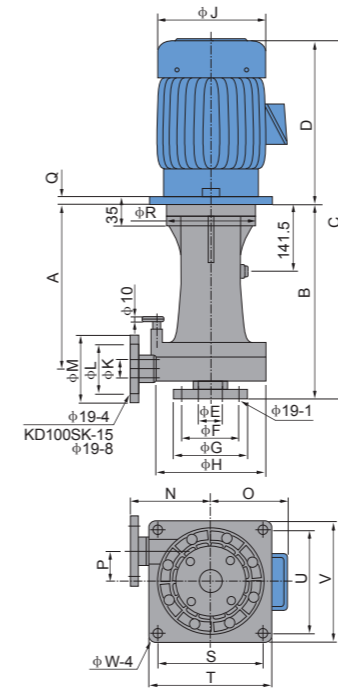

性能曲線 PERFORMANCE CURVE

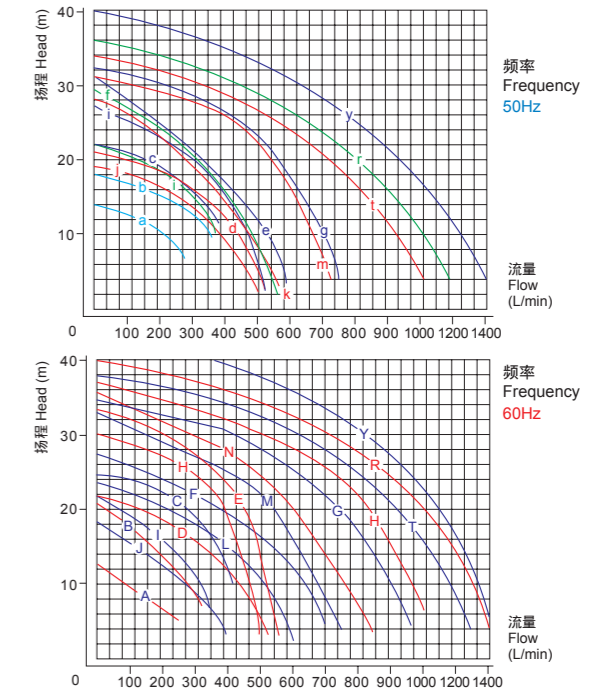

型号 Model	A	B	C	D	E	F	G	H	I	J	K	L	M	N	O	P	Q	R	S	T	U	V	W
KD-40SK/SP-1	350	425	710	285	50	120	155	230	4	177	40	105	145	170	155	65	16	186	222	260	222	260	15
KD-40SK/SP-2	350	425	755	330	50	120	155	230	4	200	40	105	145	170	165	65	16	186	222	260	222	260	15
KD-40SK/SP-3	350	425	755	330	50	120	155	230	4	200	40	105	145	170	165	65	16	186	222	260	222	260	15
KD-50SK/SP-3	350	425	755	330	65	140	177	260	4	200	50	120	155	200	165	65	16	186	222	260	222	260	15
KD-50SK/SP-5	350	425	795	370	65	140	177	260	4	238	50	120	155	200	180	65	16	186	222	260	222	260	15
KD-65SK/SP-5	350	425	795	370	78	150	190	260	8	238	65	140	177	200	180	65	16	186	222	260	222	260	15
KD-65SK/SP-7.5	350	425	865	440	78	150	190	260	8	273	65	140	177	200	240	65	20	186	300	350	300	350	18
KD-65SK/SP-10	350	425	865	440	78	150	190	260	8	273	65	140	177	200	240	65	20	186	300	350	300	350	18
KD-100SK/SP-15/20	357	436	976	540	100	175	205	290	8	323	100	175	205	217	240	88	20	186	300	350	300	350	18

KP、KPT 系列直立式耐酸碱泵

KP, KPT SERIES VERTICAL ACID AND ALKALI RESISTANT PUMP

產品特點

- 可空转使用，绝不因空运转而损坏。
- 泵浦所有接液部分，均采用耐腐蚀之FRPP、CPVC、PVDF材质，视输送的化学药液而定。
- KP/KPT系列采用C型卡簧和入口滤网装置，入口主体体积较小，更适合槽内设计使用。
- 在马达输出轴处及泵浦底部分别装置耐酸碱之密封件，双层保护可防止化学气体损坏马达轴承，而游离之化学气体将经由支撑板上的气孔顺利排出。
- 特殊设计之叶轮，即使叶轮偶尔逆转也不会损坏泵浦。
- 泵浦出口有PP和PVC两种接头，供客户方便使用。

FEATURES

- Can be used idling not damaged due to idling.
- Then fluid pumped all part of using corrosion-resistant FRPP, CPVC, PVDF material, depending on the chemical transmission of the liquid.
- KP/KPT series using C-mount and the entrance of filter devices, the main entrance of smaller, more suitable for the use of bed design.
- At motor output shaft and pumped separately at the bottom of the device seals acid, double-layer protection to prevent damage to motor bearings chemical gases, and off-axis of the chemical gas will be distributed through on-board support from the stomatal smoothly.
- Special design of the impeller, even the occasional reversal of the impeller will not damage the pump.
- Outlet has two types of PP and PVC joints for ease of use customers.



KP-40VK-1

KPT-50VK-5(PVDF)

型號意義 MODEL EXPLANATION

KP - 40 VK 1 6 V F
① ② ③ ④ ⑤ ⑥ ⑦

1. 机型编号 Model

KP SERIES KPT SERIES

2. 口径 Diameter

25-1" 40-1-1/2" 50-2"

3. 比重 Specific Gravity

VK-1.1 VP-1.4

4. 马力 Power

1/2-1/2HP 1-1HP 2-2HP
3-3HP 5-5HP

5. 频率 Frequency

5-50Hz 6-60Hz

6. O环 Ring

V-VITON E-EPT N-NBR

7. 泵体材质 Material

F-FRPP P-PVDF C-CPVC

技術參數 TECHNICAL PARAMETERS

(测试流体：水 Testing fluid: water)

型号 Model	比重 Specific Gravity	进出口径 In-outlet (mm)	马力 Power			50HZ			60HZ			重量 Weight (kg)
			相数 Phase	HP	极数 Poles	曲线 NO	扬程 Head (m)	流量 Flow (L/min)	曲线 NO	扬程 Head (m)	流量 Flow (L/min)	
KP-25VK-1/2	1.1	40×25	1/3	1/2	2	e	13	160	E	13	165	18
KP-40VK-1	1.1	50×40	1/3	1	2	f	12	280	F	15	350	19
KP-40VK-2	1.1	50×40	3	2	2	g	14	320	G	19	400	24
KP-25VP-1	1.4	40×25	1/3	1	2	i	11	200	I	12	185	18
KP-40VP-1	1.4	50×40	1/3	1	2	j	10	230	J	11	230	18
KP-40VP-2	1.4	50×40	3	2	2	k	11	250	K	15	280	24

安裝尺寸 INSTALLATION DIMENSIONS

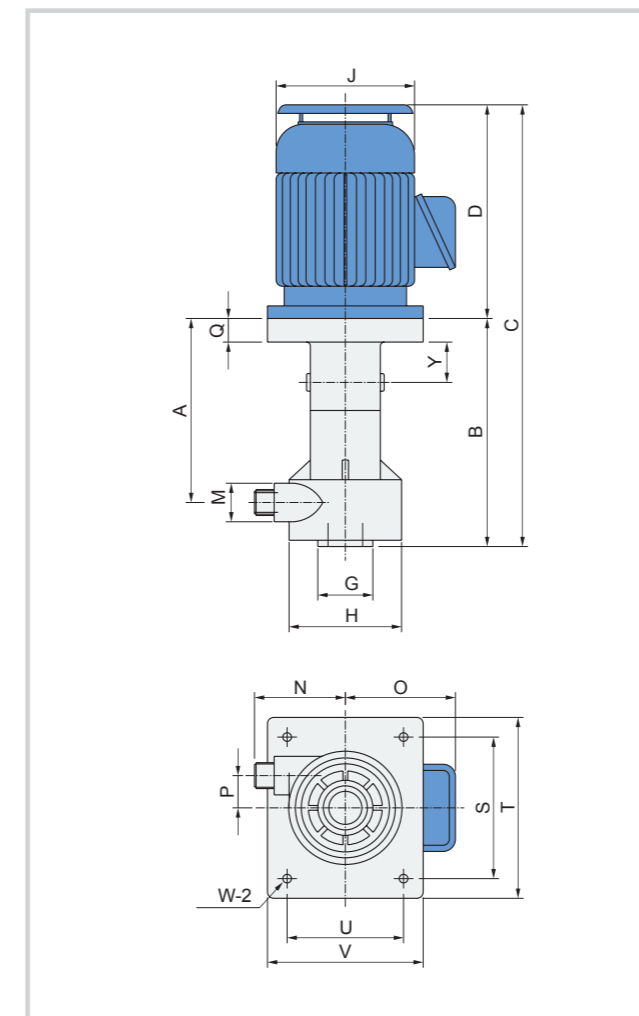

性能曲線 PERFORMANCE CURVE

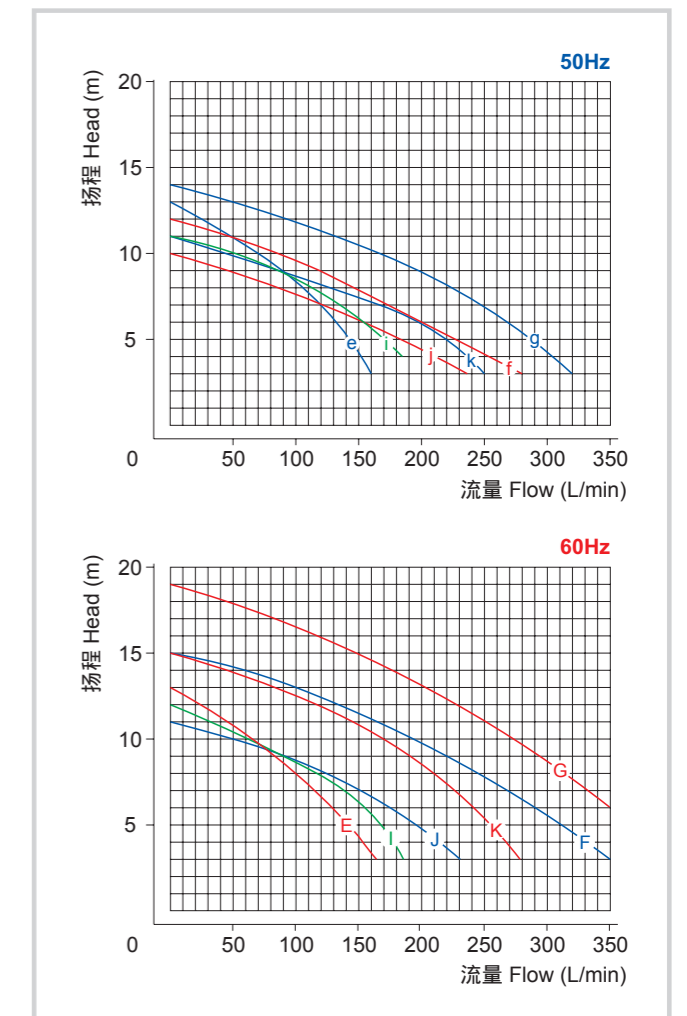

型号 Model	A	B	C	D	G	H	J	M	N	O	P	Q	S	T	U	V	W	Y
KP-25VK-1/2	234	293	528	235	70	144	177	49	115	153	41	30	180	230	150	198	15	30.5
KP-25VP-1	234	293	528	235	70	144	177	49	115	153	41	30	180	230	150	198	15	30.5
KP-40VK/VP-1	234	293	528	235	70	144	177	49	115	153	41	30	180	230	150	198	15	30.5
KP-40VK/VP-2	234	293	528	235	70	144	177	49	115	153	41	30	180	230	150	198	15	30.5

KB 系列自吸式耐酸碱泵

KB SERIES SELF-PRIMING ACID AND ALKALI RESISTANT PUMP

產品特點

- 独特的轴封设计-内装式采用 Teflon Bellow Seal 自冷式设计。
- 自吸式设计-自吸力特别强劲，自吸式可达20ft，并有止回阀设计，防止泵内液体回流。
- 耐强酸、耐强碱、抗腐蚀性强，材质有CFRPP、PVDF。
- 后封盖、轴封护罩，及脚座一体成型设计，方便维修及组装容易。
- 入口需装设底阀，以阻挡异物吸入，出口需加装逆止阀，以防止在停机时所产生的瞬间回流现象，导致泵本体损坏及泵空转受损。

FEATURES

- Unique shaft seal design - The built-in type adopts Teflon Bellow Seal self-cooling design.
- Self-priming design - The self-priming force is particularly strong, up to 20ft for the self-priming type, and the check valve design prevents the liquid inside the pump from flowing back.
- It's resistant to strong acid, alkali and corrosion, with materials CFRPP and PVDF.
- The integrated forming design of rear end cover, shaft seal shield and foot seat facilitates maintenance and assembly.
- Its inlet shall be mounted with a bottom valve to prevent foreign matters from being suctioned. Its outlet shall be mounted with a non-return valve to prevent instant reflux, which is generated on stopping, from damaging its body and idle running.



KB-50032L



KB-40012L(PVDF)

型號意義 MODEL EXPLANATION

KB - 40 02 2 N B L - C - S - H
① ② ③ ④ ⑤ ⑥ ⑦ ⑧ ⑨ ⑩

1. 机型编号 Model KB SERIES	4. 极数 Poles 2-2P	7. 扬程 Head L-低 Low H-高 High
2. 进出口口径 In-outlet 40-1-1/2" 50-2" 75-3"	5. 橡胶材质 Rubber N-NBR E-EPT V-VITON	8. 固定环 Stationary C-CERAMIC S-SIC
3. 功率 Power 01-3 0.75kW 02-3 1.5kW 03-3 2.2kW 05-3 4.0kW 07-3 5.5kW 10-3 7.5kW	6. 单向阀 Non-return Valve A-有舌 With Tongue B-无舌 Without Tongue	9. 转动环 Rotaty Ring C-CARBON S-SIC
		10. 弹簧 Spring H-HASTELLOY-C S-SUS316

技術參數 TECHNICAL PARAMETERS

型号 Model	曲线 Curve NO	最大扬程 Max Head (m)	最大流量 Max Flow (L/min)	扬程 Head (m)	流量 Flow (L/min)	进出口口径 In-outlet (mm)	马达 Motor			重量 Weight (kg)
							相数 Phase	极数 Poles	功率 Power	
KB-40012L	A	13	240	6	220	40/40	3	2	0.75	26
KB-40022L	B	17	280	10	215	40/40	3	2	1.5	30
KB-40022H	C	19	300	12	230	40/40	3	2	1.5	34
KB-50032L	D	21	410	12	300	50/50	3	2	2.2	38
KB-50032H	E	23	390	14	300	50/50	3	2	2.2	42
KB-50052H	F	27	480	15	440	50/50	3	2	4	54
KB-75052H	G	27	750	15	650	75/75	3	2	4	55
KB-75752H	H	30	850	20	750	75/75	3	2	5.5	73
KB-75102H	I	32	950	20	850	75/75	3	2	7.5	78

性能曲線 PERFORMANCE CURVE

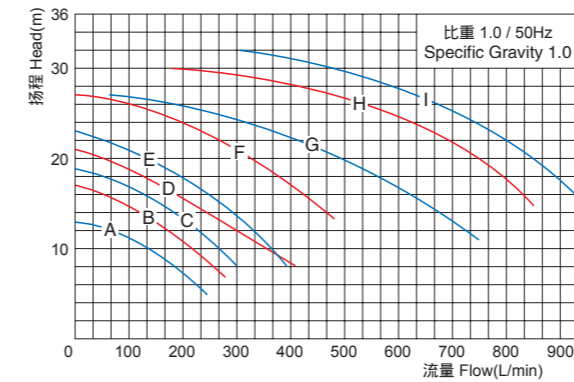

安裝尺寸 INSTALLATION DIMENSIONS

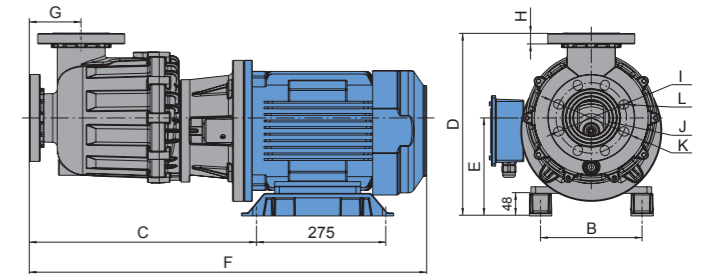

KB-75052H/75752H/75102H

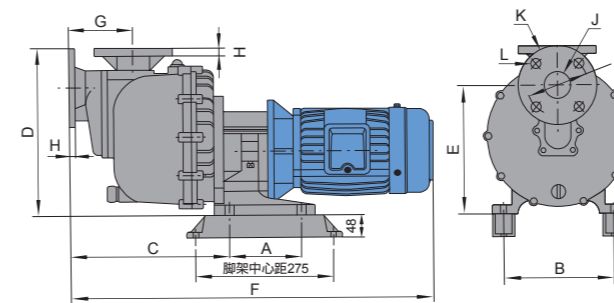

KB-40012L/40022L/40022H/50032L/50032H

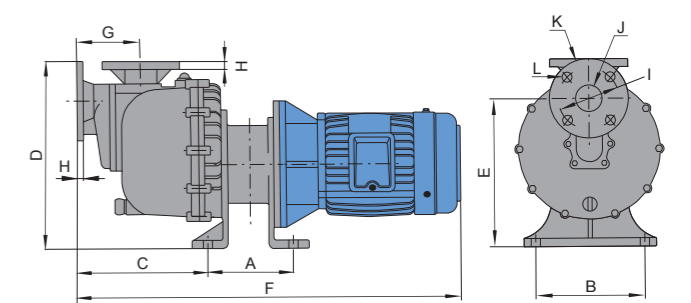

KB-50052H

型号 Model	A	B	C	D	E	F	G	H	I	J	K	L
KB-40012L	142	216	320	322	250	663	130	16	103	40	138	20
KB-40022L	142	216	320	322	250	705	130	16	103	40	138	20
KB-40022H	142	216	320	322	250	705	130	16	103	40	138	20
KB-50032L	142	216	320	322	250	705	130	18	118	50	154	20
KB-50032H	142	216	320	322	250	705	130	18	118	50	154	20
KB-50052H	168	213	272	370	290	783	130	18	118	50	154	20
KB-75052H		202	278	381	201	799	110	20	150	75	185	20
KB-75752H		216	484	387	207	846	110	20	150	75	185	20
KB-75102H		216	484	387	207	846	110	20	150	75	185	20

CDL 系列立式不銹鋼多級離心泵

CDL SERIES VERTICAL STAINLESS STEEL MULTISTAGE PUMP

產品概述

CDL系列立式多級不銹鋼離心泵是采用丹麥先進技術製造而成，其最大優點是水力模型設計先進，高效率，高節能。水泵內部葉輪、泵殼及其主要配件採用不銹鋼沖壓成形，流道特別光滑，軸瓦、軸套用硬質合金，具有超強的使用壽命，避免產生二次污染。軸封採用耐磨機械密封，無洩漏。電機採用Y2鉛外殼，進口軸承，絕緣等級F級。泵運轉平穩，低噪音，整機質量可靠，外形美觀、體積小、重量輕、運輸安裝方便，是理想的綠色、環保、節能的水泵。



CDLF 4



CDLF 16

PRODUCT INTRODUCTION

The CDL series vertical multistage stainless steel centrifugal pump adopts advanced technology from Denmark. Its biggest advantage lies in its advanced, efficient and energy-saving hydraulic model. The water pump's internal impeller, casing and main accessories adopt stainless steel stamping forming. Its flow channel is particularly smooth; and its bushing and sleeve adopt hard alloy with a strong service life to avoid secondary pollution. Its shaft seal adopts abrasion-resistance mechanical seal with zero leakage. Its motor adopts Y2 lead casing and imported bearing with insulation class F. It's an ideal green, environment-friendly and energy-saving water pump due to its stable operation, low noise, reliable overall quality, attractive appearance, compactness, light weight and easy transportation and installation.

型號意義 MODEL EXPLANATION

CDL F 4 - 160

級數 Stage × 10

額定流量 Rated Flow (m³/h)

(普通型略) 過流部件為不銹鋼304或316

(N/A for common type) The flow passage part adopts stainless steel 304 or 316.

輕型立式多級離心泵

Light-duty vertical multistage centrifugal pump

技術參數 TECHNICAL PARAMETERS

型号 Model	流量 Flow (m ³ /h)	揚程 Head (m)	轉速 Speed (r/min)	功率 Power (kW)	型号 Model	流量 Flow (m ³ /h)	揚程 Head (m)	轉速 Speed (r/min)	功率 Power (kW)
25CDL2-20	2	15	2900	0.37	32CDL4-220	4	176	2900	4
25CDL2-30	2	22	2900	0.37	40CDL8-20	8	18	2900	0.75
25CDL2-40	2	30	2900	0.55	40CDL8-30	8	27	2900	1.1
25CDL2-50	2	37	2900	0.55	40CDL8-40	8	36	2900	1.5
25CDL2-60	2	45	2900	0.75	40CDL8-50	8	45	2900	2.2
25CDL2-70	2	52	2900	0.75	40CDL8-60	8	54	2900	2.2
25CDL2-80	2	60	2900	1.1	40CDL8-70	8	63	2900	3
25CDL2-90	2	67	2900	1.1	40CDL8-80	8	72	2900	3
25CDL2-100	2	75	2900	1.1	40CDL8-90	8	81	2900	4
25CDL2-110	2	82	2900	1.1	40CDL8-100	8	90	2900	4
25CDL2-120	2	90	2900	1.5	40CDL8-110	8	99	2900	4
25CDL2-130	2	97	2900	1.5	40CDL8-120	8	108	2900	4
25CDL2-140	2	105	2900	1.5	40CDL8-130	8	117	2900	5.5
25CDL2-150	2	112	2900	1.5	40CDL8-140	8	126	2900	5.5
25CDL2-160	2	120	2900	1.5	40CDL8-150	8	135	2900	5.5
25CDL2-170	2	127	2900	1.5	40CDL8-160	8	144	2900	5.5
25CDL2-180	2	135	2900	2.2	40CDL8-170	8	153	2900	7.5
25CDL2-190	2	142	2900	2.2	40CDL8-180	8	162	2900	7.5
25CDL2-200	2	150	2900	2.2	40CDL8-190	8	171	2900	7.5
25CDL2-210	2	157	2900	2.2	40CDL8-200	8	180	2900	7.5
25CDL2-220	2	165	2900	2.2	50CDL16-20	16	24	2900	2.2
25CDL2-230	2	172	2900	3	50CDL16-30	16	36	2900	3
25CDL2-240	2	180	2900	3	50CDL16-40	16	48	2900	4
25CDL2-250	2	187	2900	3	50CDL16-50	16	60	2900	5.5
25CDL2-260	2	195	2900	3	50CDL16-60	16	72	2900	5.5
32CDL4-20	4	16	2900	0.37	50CDL16-70	16	84	2900	7.5
32CDL4-30	4	24	2900	0.55	50CDL16-80	16	96	2900	7.5
32CDL4-40	4	32	2900	0.75	50CDL16-90	16	108	2900	11
32CDL4-50	4	40	2900	1.1	50CDL16-100	16	120	2900	11
32CDL4-60	4	48	2900	1.1	50CDL16-110	16	132	2900	11
32CDL4-70	4	56	2900	1.5	50CDL16-120	16	144	2900	11
32CDL4-80	4	64	2900	1.5	50CDL16-130	16	156	2900	15
32CDL4-90	4	72	2900	2.2	50CDL16-140	16	168	2900	15
32CDL4-100	4	80	2900	2.2	65CDL32-20	32	27	2900	4
32CDL4-110	4	88	2900	2.2	65CDL32-30	32	40	2900	5.5
32CDL4-120	4	96	2900	2.2	65CDL32-40	32	53	2900	7.5
32CDL4-130	4	104	2900	3	65CDL32-50	32	67	2900	11
32CDL4-140	4	112	2900	3	65CDL32-60	32	81	2900	11
32CDL4-150	4	120	2900	3	65CDL32-70	32	95	2900	15
32CDL4-160	4	128	2900	3	65CDL32-80	32	109	2900	15
32CDL4-170	4	136	2900	4	65CDL32-90	32	124	2900	18.5
32CDL4-180	4	144	2900	4	65CDL32-100	32	138	2900	18.5
32CDL4-190	4	152	2900	4	65CDL32-110	32	153	2900	22
32CDL4-200	4	160	2900	4	65CDL32-120	32	174	2900	22
32CDL4-210	4	168	2900	4	65CDL32-130	32	189	2900	30

KS 系列不銹鋼同軸離心泵

KS SERIES STAINLESS STEEL COAXIAL CENTRIFUGAL PUMP

產品概述 PRODUCT INTRODUCTION

- 特殊设计之叶轮，效率高、寿命长、声音小、机体小，且吸水扬水性能特佳，采用不锈钢轴，经久耐用，马力1/2HP~40HP。
- 泵体及轴封材质，需依化学药液性质加以选择，以免损坏泵。
- 适用于纯水业、化工业、表面处理业等各行业。
- The special design of the impeller, high efficiency, long life, low noise and small body, and the pumping performance characteristics, adopt the stainless steel shaft, durable, power 1/2HP~40HP.
- The pump body and shaft seal material, must according the chemical physic liquid to choose, so as not to damage the pump.
- Suitable for water industry, chemical industry, surface treatment industry and other industries.



KS-75-5

型號意義 MODEL EXPLANATION

KS - 40 - 1 - C - 4 - N - H - 50

① ② ③ ④ ⑤ ⑥ ⑦ ⑧

1. 机型号 Model	2. 进出口径- 内牙式 In-outlet	6. O环材质 O-Ring Material
KS SERIES	25:1" 40:1-1/2" 50:2" 65:2-1/2" 75:3" 100:4"	N-NBR V-VITON
3. 马力 Power	4. 轴封材质 Shaft Seal Material	7. 特殊规格 Special Specifications
1/2:1/2HP 1:1HP 2:2HP 3:3HP 5:5HP 7.5:7.5HP 10:10HP 15:15HP 20:20HP 25:25HP 30:30HP 40:40HP	C-陶瓷 Ceramics S-SIC	H-高扬程 High-lift
	5. 泵体材质 Pump Body	8. 频率 Frequency
	4:SUS 304 6:SUS 316	5:50Hz 6:60Hz

技術參數 TECHNICAL PARAMETERS

型号 Model	马力 Power (HP)	进出口径 In-outlet (inch)	流量 Flow (L/min)											
			10M	15M	20M	25M	30M	35M	40M	45M	50M	55M		
KS-25-12	1/2	1"×1"	110	40										
KS-40-1	1	1-1/2"×1-1/2"	210	160										
KS-40-1-H	1	1-1/2"×1-1/2"		140	90									
KS-40-2	2	1-1/2"×1-1/2"	280	250	190		170							
KS-50-2	2	2"×2"	360	280	210									
KS-50-3	3	2"×2"	450	400	320	210								
KS-50-3-H	3	2"×2"	360	350	300		240	200						
KS-65-3	3	2-1/2"×2-1/2"	700	500	330									
KS-50-5	5	2"×2"		500	480		400	370	250					
KS-65-5	5	2-1/2"×2-1/2"	870	800	700		550							
KS-75-5	5	3"×3"	1100	910	750		600							
KS-50-7.5	7.5	2"×2"	350	305	280		240	230	215	205	190	180		
KS-75-7.5	7.5	3"×3"	1000	950	820		750	620	450					
KS-75-10	10	3"×3"	975	910	800		700	650	600	550	420			
KS-100-10	10	4"×4"	1360	1315	1140		975	765						

KG 系列一般同軸耐酸碱泵

KS SERIES GENERAL COAXIAL ACID AND ALKALINE RESISTANT PUMP

產品概述 PRODUCT INTRODUCTION

- 适用温度：FRPP, PVDF -85 以下，依各种化学性之不同而定。
- 选择各种泵体材质，可耐强酸强碱及用在氟化系列之化学性。
- 独特的轴封设计：采用Teflon Bellows Seal 自冷式，依各种化学性选择轴封材质Sic, Carbon, Ceramic。
- 后封盖为组合式，组装简易，无冷却循环回路设计，不可空转使用。
- Applicable temperature: FRPP, PVDF -85°C or less.
- Choose a variety of pump body material, resistant to acid and alkali and used in chemical fluoride series.
- Unique seal design: using a Teflon bellows seal self cooling, according to a variety of chemical selection of seal material SiC, carbon, ceramic.
- After the lid is combined, no cooling circuit design, can not use idle.

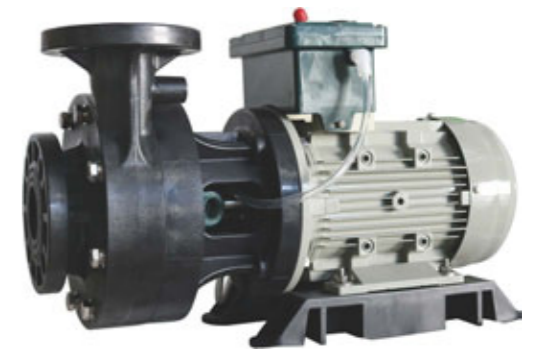

KG-75052

型號意義 MODEL EXPLANATION

KG - 40 02 2 - N H - C C H - 5 N

① ② ③ ④ ⑤ ⑥ ⑦ ⑧ ⑨ ⑩ ⑪

1. 机型号 Model	4. 极数 Poles	8. 转动环 Rotating Ring
KG-泵体材质 FRPP KGK-泵体材质 PVDF	2-2P	C-碳素 Carbon S-SSIC
2. 进出口径 In-outlet	5. 橡胶材质 Rubber	9. 弹簧 Spring
40-1-1/2" 50-2" 75-3" 100-4" 125-5"	N-NBR E-EPDM V-VITON	H-Hastelloy-C S-SUS316
3. 马力 Power	6. 特殊规格 Special Specifications	10. 频率 Frequency
01-1HP 02-2HP 03-3HP 05-5HP 07-7.5HP 10-10HP 15-15HP	H-高扬程 High-lift	5-50Hz 6-60Hz
	7. 固定环 Fixing Ring	11. 型别 Typed
	C-陶瓷 Ceramics S-SSIC	N-标准机型 Standard model T-钛轴心 Titanium axis

技術參數 TECHNICAL PARAMETERS

(测试流体：水，比重：1.0 Testing Fluid: Water, Specific Gravity 1.0)

型号 Model	进出口径 In-outlet (mm)	马力 Power		50Hz		60Hz		重量 Weight (kg)
		相数 Phase	HP	全扬程 Head (m)	全流量 Flow (L/min)	全扬程 Head (m)	全流量 Flow (L/min)	
KG-40012	40×40	3	1	15	250	15	240	21
KG-10022	40×40	3	2	17	320	21	330	30
KG-40032	40×40	3	3	25	400	26	430	33
KG-50032	50×50	3	3	25	530	30	460	34
KG-50052	50×50	3	5	28	635	35	560	47
KG-75052	75×75	3	5	19.5	880	30	850	49
KG-75072	75×75	3	7.5	24	930	33	980	76
KG-72102	75×75	3	10	29	950	35	1100	80
KG-100102	100×100	3	10	27.5	1180	32	1500	81
KG-100152	100×100	3	15	30	1490	45	1750	110
KG-125152	125×125	3	15	30	2100	30	2000	112

R Y F 系列一體成型過濾器 R Y F SERIES ONE-PIECE FILTER

產品概述 PRODUCT INTRODUCTION

- 结构简单：過濾器由主體、網籃、上蓋組成。
- 主體：過濾器腔體與出入口法蘭、主體上端面法蘭、安裝方形底座、支撐網籃固定片一體注塑成型，无任何螺紋與焊接，保證了產品安全密封，无任何滲液及損壞。
- 法蘭螺絲孔距多功能，可配國標、美標、日標、德標法蘭。
- 安裝的方形底座增強了本產品的安全性及穩固性、便于固定在不同需求的地方。
- 四孔安裝方形底座內底抬高，便于清洗本產品內部及過濾介質的排放。
- 材質特殊：PVDF、PPH、PPR等塑料材質過濾器，能用于高溫高濃度的鹽酸、硫酸、王水等強酸強鹼的藥液過濾及大部份化學藥液過濾。



型號意義 MODEL EXPLANATION

R Y F - 2 B - 50 - P - V - K - S

1 2 3 4 5 6 7 8

1. 機型編號 Model

R Y F SERIES

2. 濾袋尺寸 Filter Bag Size

1- 180×430mm 2- 180×810mm
4- 105×380mm 5- 150×510mm
6- 180×560mm

4. 出入口徑 In-outlet

40-40mm 50-50mm
65-65mm 80-80mm

3. 上蓋型式 Upper Cover style

A-旋牙上蓋 Spiral upper cap
B-吊環壓蓋 Ring gland
C-頂入式上蓋 Top cover
AX-旋牙上蓋，進出水口為活接式
Spiral tooth upper cover, inlet and outlet for the flexible connection

5. 主體材質 Main Material

P-PPH V-PVDF

6. 橡膠材質 Rubber

V-VITON E-EPDM P-PFA

7. 保護開關 Protection Switch

N-不帶保護開關
K-安裝保護開關（微動開關型）
N-Unprotected switch
K-With protective switch (micro switch)

8. 特殊代碼 Special Code

S-有金屬配件標配為SUS316
T-有金屬配件為Ti

技術參數 TECHNICAL PARAMETERS

型號 Model	進出口徑 In-outlet (mm)	濾袋 Filter Bags (mm)	過濾面積 Filtering Area (m ²)	壳体容量 / 重量 Housings Capacity / Weight (L / kg)	最大流量 Max. Flow (m ³ /h)	最大工作壓力 Max Pressure (MPa)	工作溫度 Operating Temperature (°C)
R Y F-4A-40	40×40	105×380	0.12	6.5 / 4	12	0.6	70
R Y F-4A-40	40×40	105×380	0.12	6.5 / 5.9	12	0.8	90
R Y F-5A-50	50×50	150×510	0.3	12.8 / 10.8	22	0.8	90
R Y F-1A-50	50×50	180×430	0.25	20.3 / 15.3	20	0.8	90
R Y F-6A-65	65×65	180×560	0.35	24 / 18	25	0.8	90
R Y F-2A-50	50×50	180×810	0.5	32 / 24.2	40	0.8	90
R Y F-2A-65	65×65	180×810	0.5	32 / 24.2	40	0.8	90
R Y F-2B-50	50×50	180×810	0.5	32 / 24.2	40	0.8	90
R Y F-2B-65	65×65	180×810	0.5	32 / 24.2	40	0.8	90
R Y F-2C-65	65×65	180×810	0.5	32 / 24.2	40	0.8	90

K X 系列化學藥液過濾器 K X SERIES CHEMICAL LIQUID MEDICINE FILTER

產品特點

- 過濾機桶身及腳座採用模具化生產方式一體成型，并在桶身形成增加強度的肋條。
- 過濾機桶身材質可為PP、CPVC、PVDF，依藥液酸鹼濃度性質及溫度特性，直接射出成型。
- 過濾機焊點業界最少，大幅降低假性焊接滲漏之虞。
- 選擇性採用自吸式或磁驅式泵，其中無軸封磁驅式泵浦能有效防止空轉滲漏、污染環境等問題發生。
- 馬達防護罩確保馬達在酸氣中不易受腐蝕。
- 特別适用于電鍍液、化學液、純水循環過濾等用途。
- 可依客戶作不同濾材之變化（濾心式、層疊濾心式、濾紙式、楊桃式、袋濾式），操作簡便。
- 高精度過濾，過濾面積廣，效率高，清洗容易。
- 另有鈦束環組可供選擇。
- 標準配件：出入口由任式或法蘭式（含墊片及PVC螺絲）。
- 選購配件：開關（含護罩）、底閥或逆止閥、視流器、出入口軟管、濾袋等等。

FEATURES

- One piece injected without welding of filter body and stand are adopted the integrative mould and increase the intensity of the filter body with the projection rib.
- According to the chemical density and temperature feature to inject the filter body. The material of filter body is made of PP, CPVC, or PVDF.
- The least welding of filter in filter field, it greatly decreases the leakage.
- Assemble with self-priming pump or magnet drive pump is depending on customers. If with magnet drive pump, it can avoid the problems of dry running leakage and environment pollution.
- Motor guard which avoids the motor be corroded in acid environment.
- Excellent application to circulated filtering operations for plating liquid, chemical liquid and pure water.
- According to customer's requirement, various filter elements for choice and easy to operate: Lock Core Filter, Pressure Core Filter, Pressure Layered Core Filter, Bag Filter, Paper Filter, and Bellow Filter.
- The filter provides high precision with wide filter area, high efficiency, easy to operate and clean.
- Titanium (Ti) clamp set also can be provided as choice.
- Standard accessories: union or flange (with gasket and PVC screws).
- Purchase accessories: switch (including guard), foot valve, check valve, flow-seeing tube, in/outlet flexible, or filter bag, etc.

型號意義 MODEL EXPLANATION

K X - 1004 - F - U - N - C - J - S - M P

1 2 3 4 5 6 7 8 9

1. 機型編號 Model

K X SERIES

2. 機型代號 Core Number

1001 - 10"×1PCS 2004 - 20"×4PCS
1002 - 10"×2PCS 2006 - 20"×6PCS
2001 - 20"×1PCS 2008 - 20"×8PCS
2002 - 20"×2PCS 2012 - 20"×12PCS
1004 - 10"×4PCS 2018 - 20"×18PCS

3. 濾桶材質 Material of Filter Body

F-PP A-CPVC P-PVDF

4. 出入口型式 Type of In/outlet

U-由任式 Union F-法蘭式 Flange

5. 密封材質 Material of Seal Packing

N-NBR V-VITON

6. 濾材型式 Type of Filter Cores

C-濾心壓板式 Pressure Core Filter
B-濾心螺帽式 Lock Core Filter
T-層疊濾心壓板式 Pressure Layered Core Filter
K-楊桃濾布式 Bellow Filter
P-濾紙式 Paper Filter
U-袋濾式 Bag Filter

7. 出入口規格 Specification of In/outlet

J-JIS D-DIN A-ANSI

8. 束環組材質 Material of Clamp

S-SUS304 T-鈦 Ti

9. 泵浦型式 Model of Pump

KB Series-自吸式 Self-priming Pump
MP Series-磁驅式 Magnetic Drive Pump
MPX Series-磁驅式 Magnetic Drive Pump



KX-2001

KX-2004

KX-2006(PVDF)

KX-2018(PVDF)



KX-3018

KX-2018

KX-2008

KX-1004

技術參數 TECHNICAL PARAMETERS

型号 Model	KX-1001	KX-1002	KX-2001	KX-2002	KX-1004	KX-2004	KX-2006	KX-2008-1	KX-2008-2	KX-2012	KX-2018	KX-3018	
泵浦型式 Model of Pump	MP(MD)	MP(MD)	MP(MD)	MP/MPX	MP(MD)/MPX	MP(MD)/MPX	KB/MPH/MPX	KB/MPH/MPX	KB/MPH/MPX	KB/MPH/MPX	KB/MPH/MPX	KB/MPH/MPX	
泵浦馬達 Pump Motor (50Hz/60Hz)	45W	65W	65W	150W/180W	255W/265W	255W/265W	1/2~1HP	1HP	2HP	2HP	3~5HP	3~5HP	
濾材 Filter Material	濾心螺帽式 B Type	10"×1	10"×2	20"×1	20"×2	10"×4	20"×4	20"×6	20"×8	20"×8	20"×12	20"×18	30"×18
	濾心壓板式 C Type	-	-	-	-	-	-	20"×6	20"×8	20"×8	20"×12	20"×18	30"×18
	層疊濾心式 T Type	-	-	-	-	-	-	20"×6	20"×8	20"×8	20"×12	20"×18	30"×18
	楊桃濾布式 K Type	-	-	-	-	-	-	1 SET	1 SET	1 SET	1 SET	1 SET	1 SET
	濾紙式 P Type	-	-	-	-	129×23PCS	129×46PCS	195×45PCS	232×45PCS	232×45PCS	300×40PCS	370×40PCS	370×60PCS
	袋濾式 U Type	-	-	-	-	φ4"×9"L	φ4"×15"L	φ7"×16"L	φ7"×16"L	φ7"×16"L	φ7"×16"L	φ7"×16"L	φ7"×32"L
適用電鍍槽 Applicable Electrode Plated Tank	200L	400L	400L	600L	600L	800L	1~2 Ton	1~3 Ton	1.5~3 Ton	2.5~4 Ton	4~6.5 Ton	6~7.5 Ton	
過濾量 Filtrering Capacity (L/min)	15	30	30	60	60	80	150	180	220	220	330~500	400~600	
過濾面積 Filtering Area (m ²)	濾心式 B, C Type	0.125	0.25	0.25	0.5	0.5	1	1.5	2	2	3	4.5	6.7
	層疊濾心式 T Type	-	-	-	-	-	-	0.7	0.9	0.9	1.3	2	3
	楊桃濾布式 K Type	-	-	-	-	-	-	1.1	1.7	1.7	2.4	4.4	-
	濾紙式 P Type	-	-	-	-	0.3	0.6	1.5	2.2	2.2	3.6	5.4	-
	袋濾式 U Type	-	-	-	-	0.5	1.0	2.0	2.0	2.0	2.0	2.0	4.4
出入口徑 Outlet/inlet Dimensions (inch)	3/4	3/4	3/4	1	1	1	1.5	1.5/1.5*2	1.5/1.5*2	1.5/1.5*2	2	2	
外型尺寸 Dimensions (L×W×H) (mm)	500×312×830	573×360×900	500×312×1100	573×360×1185	573×360×900	573×360×1185	785×487×1510	785×487×1510	785×487×1510	865×625×1555	865×625×1555	865×625×1760	
機體重量 Weight (kg)	15	17.5	17	24	28	30	70	77	77	97	117	125	

尺寸圖 DIMENSIONAL DRAWING

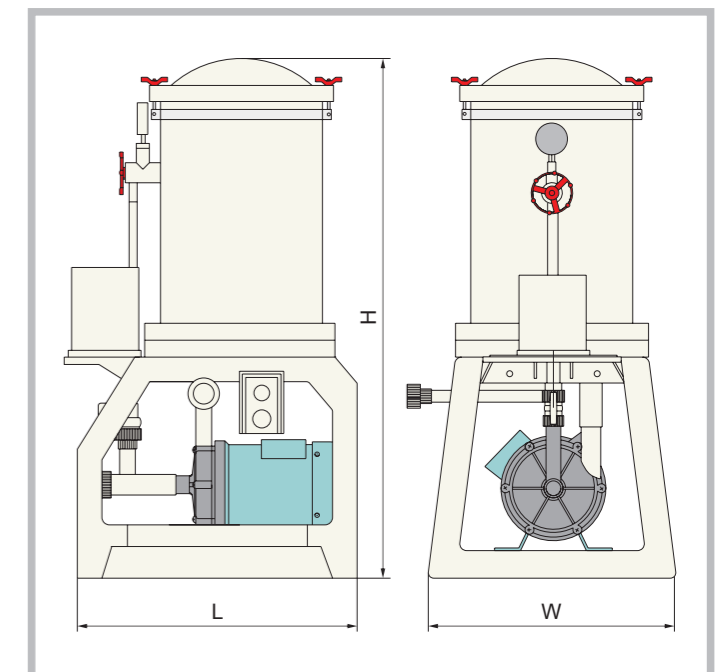

KTS 系列雙塔過濾機

KTS SERIES DOUBLE-TOWER FILTER

產品特點

- 本机采用双塔过滤桶设计，第一塔主要用于将药水中的颗粒杂质过滤掉；第二塔进行活性炭过滤，去除药水中的有机化合物，然后经由第三道活性炭桶下半部的滤芯过滤，让所过滤药液更清洁。
- 第一塔内的滤材可选择滤芯，滤纸，杨桃式，滤管式，可互换。

FEATURES

- This filter is designed with double-tower filter vat. The first tower is mainly used to filter granular impurities in the liquid medicine; the second tower removes organic compounds in the liquid medicine through active carbon filtration; and then the third step is to filter the liquid medicine through the filter element in the lower part of the active carbon vat, making the liquid medicine cleaner.
- The filter medium in the first tower is optional for filter element, filter paper, carambola and filter tube, which are interchangeable.



KTS-2008



KTS-2018

技術參數 TECHNICAL PARAMETERS

(测试流体：水，比重：1.0 Testing fluid: water, specific gravity 1.0)

型号 Model	KTS-2008-2	KTS-2012-2	KTS-2018-3
适合电镀槽 Applicable for plating bath(Ton)	1.5~3	2.5~4	4~6.5
过滤量 Filtration capacity (L/min)	200	250	330
第一塔 First tower	滤芯锁帽式 Filter element locking nut	20"×6支 pc	20"×12支 pc
	滤芯压板式 Filter element pressure plate	20"×6支 pc	20"×12支 pc
	滤纸式 Filter paper type	234×40片 pc	370×40片 pc
温度范围 Temperature range ()	70	≤70	≤70
功率 Power (HP)	2	2	3
第二塔滤材 (滤芯10"×6) Filter medium of second tower (filter element 10"×6)	滤芯滤袋双层式活性炭袋一个，滤芯压板双层式活性炭袋一个 Filter element filter bag double-layer active carbon bag, 1pc Filter element pressure plate double-layer active carbon bag, 1pc		
第一塔入口径 First tower inlet diameter	1-1/2"	1-1/2"	2"
第二塔出口径 Second tower outlet diameter	1-1/2"	1-1/2"	1-1/2"
机体重量 Weight (kg)	135	150	165

KDF 系列化學鍍專用過濾機

KDF SERIES CHEMICAL PLATING FILTER

產品特點 FEATURES

- 本机为化学镀专用机器。
- 过滤桶采用PP材质制作，具有耐高温、耐酸碱的特性。
- 此机使用可空转式耐酸碱泵，因而符合化学镀液的特性，让化学镀液不会沉附在泵上而使泵损坏。
- This filter is specially for chemical plating.
- Its filter vat is made of PP, characterized by resistance to high temperature, acid and alkali.
- This filter uses the acid and alkali resistant pump with resistance to idle running, thus it conforms to characteristics of chemical plating solution so that the chemical plating solution will not sink and be attached on the pump to damage the pump.

型號意義 MODEL EXPLANATION

KDF - 2006 - 1 - P - F - N - C

- C : 滤芯压板式 Filter element press plate type
- B : 滤芯螺帽式 Filter element nut type
- N : 密封橡胶NBR Seal rubber NBR
- V : 密封橡胶VITON Seal rubber VITON
- U : 出入口由任式 Union type outlet/inlet
- H : 出入口套管式 Sleeve type outlet/inlet
- F : 出入口法兰式 Flange type outlet/inlet
- P : 泵体材质FRPP Material FRPP
- K : 泵体材质PVDF Material PVDF
- 马力 Power: 1-1HP, 2-2HP, 3-3HP
- 型式编号 Type
- 机型编号 Model



KDF-2006



KDF-2008



KDF-2018

技術參數 TECHNICAL PARAMETERS

型号 Model	进出口径 In-outlet (mm)	极数 Poles	功率 Power (HP)	全扬程 Head (m)	全流量 Flow (L/min)
KDF-1004-1/3HP	25×25	2	1/3	3	40
KDF-2004-1/2HP	25×25	2	1/2	8	80
KDF-2006-1HP	40×40	2	1	8	160
KDF-2008-2HP	40×40	2	2	10	180
KDF-2012-2HP	40×40	2	2	11	220
KDF-2018-3HP	50×50	2	3	11	330

KCL 系列鉻酸過濾機 KCL SERIES BICHROMATE FILTER

產品特點 FEATURES

- 本机适合铬酸镀液循环过滤用。
- 最高使用温度不能超过60℃。
- 过滤桶部分采用PVC材质，泵浦部分采用PVDF材质。
- 滤材部分采用锁帽式设计，密封性好。过滤面积广，药液接触部分无金属部件。
- This filter is applicable for circulating filtration of chromic acid plating solution.
- The maximum working temperature shall not exceed 60°C.
- The filter's vat part adopts PVC and the pump part adopts PVDF.
- The filter medium part adopts the locking nut design with good airtightness. Its filtration area is wide and there are no metal components for those contacting the liquid medicine.

型號意義 MODEL EXPLANATION

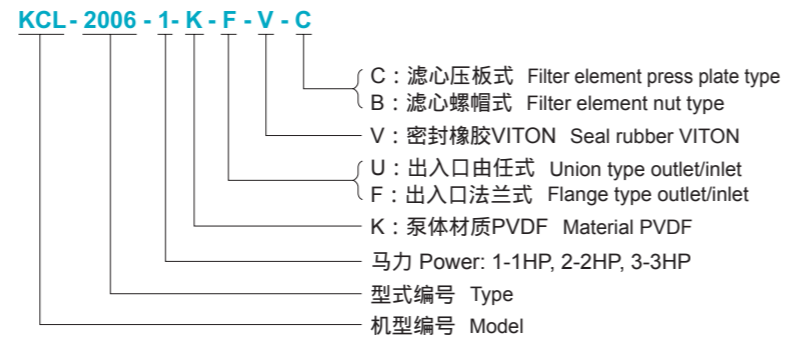

KCL-2004



KCL-2006

技術參數 TECHNICAL PARAMETERS

型号 Model	进出口径 In-outlet (mm)	极数 Poles	功率 Power (HP)	全扬程 Head (m)	全流量 Flow (L/min)
KCL-1004	25×25	2	1/3	3	40
KCL-2004	25×25	2	1/2	8	80
KCL-2006-1HP	40×40	2	1	8	160
KCL-2008-2HP	40×40	2	2	10	180
KCL-2012-2HP	40×40	2	2	11	220
KCL-2018-3HP	50×50	2	3	11	330

KTT 系列活性炭處理過濾機 KTT SERIES ACTIVE CARBON PROCESSING FILTER

產品特點 FEATURES

- 本机采用PP注塑成型，可耐高温，耐酸碱。
- 可以于滤袋中置入活性炭颗粒，作为处理药水用，并经过活性炭袋下部的滤芯重新过滤一遍，使被处理的药液更加清洁。
- This filter adopts PP injection moulding, resistant to high temperature, acid and alkali.
- Active carbon grains can be put into the filter bag to process the solution which then is filtered again by the filter element in the lower part of the active carbon bag, making the liquid medicine cleaner.

型號意義 MODEL EXPLANATION

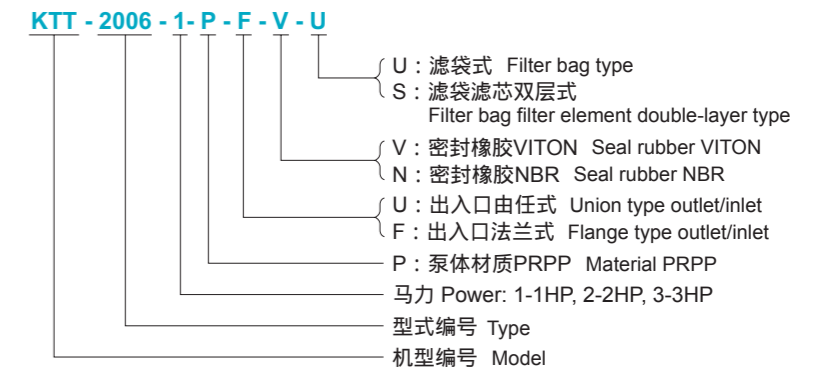

KTT-2006



KTT-2018-II

技術參數 TECHNICAL PARAMETERS

型号 Model	进出口径 In-outlet (mm)	极数 Poles	功率 Power (HP)	全扬程 Head (m)	全流量 Flow (L/min)
KTT-1004	25×25	2	1/3	3	40
KTT-2004	25×25	2	1/2	8	80
KTT-2006-1HP	40×40	2	1	8	160
KTT-2008-2HP	40×40	2	2	10	180
KTT-2012-2HP	40×40	2	2	11	220
KTT-2018-3HP	50×50	2	3	11	330
KTT-2006-II-1HP	40×40	2	1	19	230
KTT-2010-II-2HP	40×40	2	2	19	250
KTT-2018-II-3HP	50×50	2	3	23	310

KTA 化學藥液過濾器 KTA CHEMICAL LIQUID MEDICINE FILTER

產品特點

- 本机采用PP材质注射成型，适合于大部分化学药液过滤。
- 滤材有滤芯锁帽式、压板式、滤纸式、杨桃式、滤管式、滤袋式可选，可互换。
- 可根据客户要求，上下盖用PP实板加工成套，满足客户使用到高压场合。



KTA-2001

KTA-2004

KTA-2006

KTA-2012

型號意義 MODEL EXPLANATION

KTA - 1004 - F - U - N - C - J - S

① ② ③ ④ ⑤ ⑥ ⑦ ⑧

1. 机型编号 Model

KTA SERIES

2. 机型代号 Core Number

1001 - 10"×1PCS	2004 - 20"×4PCS
1002 - 10"×2PCS	2006 - 20"×6PCS
2001 - 20"×1PCS	2008 - 20"×8PCS
2002 - 20"×2PCS	2012 - 20"×12PCS
1004 - 10"×4PCS	2018 - 20"×18PCS

3. 滤桶材质 Material of Filter Body

F-PP A-CPVC P-PVDF

4. 出入口型式 Type of In/outlet

U-由任式 Union F-法兰式 Flange

5. 密封材质 Material of Seal Packing

N-NBR V-VITON

6. 滤材型式 Type of Filter Cores

C-滤心压板式 Pressure Core Filter
B-滤心螺帽式 Lock Core Filter
T-层叠滤心压板式 Pressure Layered Core Filter
K-杨桃滤布式 Bellow Filter
P-滤纸式 Paper Filter U-袋滤式 Bag Filter

7. 出入口规格 Specification of In/outlet

J-JIS D-DIN A-ANSI

8. 束环组材质 Material of Clamp

S-SUS304 T-钛 Ti

FEATURES

- This filter adopts PP injection moulding, applicable for filtration of most liquid medicines;
- The filter medium options include: filter element locking nut, pressure plate, filter paper, carambola, filter tube and filter bag, which are inter changeable;
- The top and bottom covers can be customized into a package with PP solid plate to meet the need for high-pressure applications of customers.



KTA-2018(PVDF)

KTA-2012(PVDF)

KTA-2008(PVDF)

KTA-2001(PVDF)

技術參數 TECHNICAL PARAMETERS

型号 Model	1001	2001	1004	2004	2006-1	2008-1	2008-2	2012	2018	3018	
过滤量 Filtration capacity (L/min)	15	30	60	80	150	180	220	250	330	430	
适合电镀槽 Applicable for plating bath(m³)	0.2	0.3	0.6	0.8	1-2	1.5-2.5	2-3	2.5-4	4-6.5	6-7	
滤材 Filter Material	滤心螺帽式 B Type	10"×1	20"×1	10"×4	20"×4	20"×6	20"×8	20"×8	20"×12	20"×18	30"×18
	滤心压板式 C Type	-	-	-	-	20"×6	20"×8	20"×8	20"×12	20"×18	30"×18
	层叠滤心式 T Type	-	-	-	-	20"×6	20"×8	20"×8	20"×12	20"×18	30"×18
	杨桃滤布式 K Type	-	-	-	-	1 SET	1 SET	1 SET	1 SET	1 SET	1 SET
	滤纸式(PCS) P Type	-	-	129×23	129×46	195×45	232×45	232×45	300×40	370×40	370×60
袋滤式 U Type	-	-	φ4"×9"L	φ4"×15"L	φ7"×16"L	φ7"×16"L	φ7"×16"L	φ7"×16"L	φ7"×16"L	φ7"×32"L	
温度范围 Temperature range () PP	70	70	70	70	70	70	70	70	70	70	
出入口径 Outlet/inlet dimensions (inch)	3/4	3/4	1	1	-	1-1/2	1-1/2	1-1/2	2	2	

TK 一般型不銹鋼過濾器 TK GENERAL STAINLESS STEEL FILTER

產品特點 FEATURES

- 過濾筒採用上開式設計，不需要使用任何工具即可更換濾材。
 - 濾筒材質：SUS304、SUS316，有內牙式及活動式法蘭。
 - 可過濾一般水中雜質，一般家庭用能完全將水中雜物過濾。
 - 濾材分濾心式及濾袋式。工作壓力：4kg/cm²以內。
- The filter cartridge with open design, do not need to use any tools to replace the filter.
 - Filter material: SUS304, SUS316, with internal teeth and movable flange.
 - General can filter impurities in water, general household can completely filter debris in the water.
 - Filter cartridge and bag type branch. Working pressure: 4kg/cm².



型號意義 MODEL EXPLANATION

TK - C 20 6 - 40 B F 4 N L A S

① ② ③ ④ ⑤ ⑥ ⑦ ⑧ ⑨ ⑩ ⑪ ⑫

- TK-機型編號
- C-濾心式，B-濾袋式
- 濾心長度：10-10",20-20",30-30"
濾袋式直徑長度：
716- 7"×16" 732- 7"×32"
816- 8"×16" 832- 7"×32"
- 1-濾代1只，6-濾心6支，7-濾心7支
8-濾心8支，9-濾心9支
- 口徑：40-11/2",50-2"
- B-濾心鎖帽式
C-濾心壓板式
U-濾袋式
- 出入口接頭：F-法蘭，S-內牙口
- 材質：4-SUS304，6-SUS316
- 密封環：N-NBR,E-EPDM
V-VITON
- L-固定腳座
M-活動式腳座
- 壓力表型式：
A-PP隔膜式壓力表(膜片EPDM)
B-不銹鋼隔膜式壓力表(膜片Teflon)
C-一般壓力表
- S-濾筒內配件全不銹鋼
P-濾筒式配件為PP

技術參數 TECHNICAL PARAMETERS

型號 Model	口徑 Caliber	濾材型式 Filter Type	濾材規格 specifications	腳架 Bracket
C-106	1 1/2"~2"	濾心 C	10"×6支	固定式 L
C-206	1 1/2"~2"	濾心 C	20"×6支	固定式 L
C-306	1 1/2"~2"	濾心 C	30"×6支	固定式 L
C-107	1 1/2"~2"	濾心 C	10"×7支	固定式 L
C-207	1 1/2"~2"	濾心 C	20"×7支	固定式 L
C-307	1 1/2"~2"	濾心 C	30"×7支	固定式 L
C-108	1 1/2"~2"	濾心 C	10"×8支	活動式 M
C-208	1 1/2"~2"	濾心 C	20"×8支	活動式 M

型號 Model	口徑 Caliber	濾材型式 Filter Type	濾材規格 specifications	腳架 Bracket
C-308	1 1/2"~2 1/2"	濾心 C	30"×8支	活動式 M
C-109	1 1/2"~2"	濾心 C	10"×9支	活動式 M
C-209	1 1/2"~2"	濾心 C	20"×9支	活動式 M
C-309	1 1/2"~2 1/2"	濾心 C	30"×9支	活動式 M
C-7161	1 1/2"~2"	濾袋 B	7"×16"(1pc)	活動式 M
C-7321	1 1/2"~2"	濾袋 B	7"×32"(1pc)	活動式 M
C-8161	1 1/2"~2"	濾袋 B	8"×16"(1pc)	活動式 M
C-8321	1 1/2"~2 1/2"	濾袋 B	8"×32"(1pc)	活動式 M

SF/SH 耐高壓不銹鋼過濾器 SF/SH HIGH PRESSURE STAINLESS STEEL FILTER

型號意義 MODEL EXPLANATION

SF - 12 20 - C 50 F 4 - N L A N S

① ② ③ ④ ⑤ ⑥ ⑦ ⑧ ⑨ ⑩ ⑪ ⑫

- SF-機型代號 SH-可掀式
- 12-濾心數(4,6,8,12,20,27,39,53)
- 20-濾心長度(10",20",30")
- C-濾心壓板式 B-濾心鎖帽式
- 出入口徑：40-11/2",50-2",65-2 1/2"
80-3",4A-4",5A-5",6A-6"
- F-出入口JIS 10K 法蘭式
S-出入口JIS 10K 內牙式
- 4-SUS304，6-SUS316，T-鈦
- 橡膠：N-NBR,E-EPDM
V-VITON,T-TEFLON
- L-固定腳架，M-活動式腳架
- 壓力表型式：
A-PP隔膜式壓力表(膜片EPDM/Teflon)
B-不銹鋼隔膜式壓力表(膜片Teflon)
C-一般壓力表
- N-表面電解，S-特別內拋光
- S-濾筒內配件全不銹鋼
P-濾筒式配件為PP



SF 上蓋吊具



SF 固定腳架



SF 活動式腳架

技術參數 TECHNICAL PARAMETERS

型號 Model	進出口徑 In-outlet (inch)	濾心數(支) Filter Number (pcs)	濾心長度 Filter Length (inch)	過濾量 Filtration Capacity (L/min)	上蓋吊具 Cover Hanger
410	1"~1 1/2"	4	10	100	×
420	1"~1 1/2"	4	20	180	×
620	1 1/2"~2"	6	20	280	×
820	1 1/2"~2"	8	20	360	×
630	1 1/2"~2"	6	30	420	×
830	1 1/2"~2 1/2"	8	30	550	×
1220	2"~3"	12	20	550	×
1230	2"~3"	12	30	800	×
2020	3"~4"	20	20	900	×
2030	3"~4"	20	30	1200	×
2720	3"~4"	27	20	1100	○
2730	3"~4"	27	30	1250	○
3920	4"~5"	39	20	1500	○
3930	4"~5"	39	30	2000	○
5320	4"~6"	53	20	2000	○
5330	4"~6"	53	30	2500	○



PP隔膜式壓力表(膜片EPDM/Teflon)



不銹鋼隔膜式壓力表(膜片Teflon)

配件及其它泵 ACCESSORIES AND OTHER PUMP



材質一覽表 MATERIAL LIST

代号 Code	名称 Name	代号 Code	名称 Name
PP	聚丙烯	PFA	聚高氟烷乙醚
PPG(GFRPP)	玻纤增强聚丙烯	PVDF	聚偏二氯乙烯
CFRPP	碳纤维增强聚丙烯	EPDM	三元乙丙橡胶
PE	聚乙烯	FKM	氟橡胶
PVC	聚氯乙烯	CR	氯丁橡胶
PPS	聚苯硫醚	CE	铝陶瓷
PEEK	聚醚醚酮	高纯度CE	99%铝陶瓷
PTFE	聚四氟乙烯	SIC	碳化硅
GFRPTFE	玻纤增强乙炔聚四氟乙烯		

產品抗化學腐蝕狀況 PRODUCT ANTI-CHEMICAL CORROSION

化学药品 Chemical		材料 Material						
		聚丙烯 PP	聚四氟乙烯 PTFE	氟橡胶 FKM	丁腈橡胶 Nitrile	三元乙丙胶 EPDM	95陶瓷 95 Ceramic	高密度碳 Karbate
硫酸 Sulfuric acid	0~10%	A4	A6	A6	B2	A4	A5	A6
	10~75%	A3	A6	A4	X	A3	A5	A6
	75~100%	B2	A4	A4	-	B2	A5	A4
硝酸 Nitric acid	10%	A3	A5	A5	X	A2	A5	A6
	30%	A2	A6	A6	X	A2	A5	A6
	50%	B2	A3	A1	X	X	A5	A5
盐酸 Hydrochloric acid	0~25%	A4	A6	A3	B1	A3	A5	A6
	25~40%	A4	A6	B2	X	C2	A5	A6
氢氟酸 Hydrofluoric acid	10%	B2	A6	A3	X	A3	-	A3
	30%	C2	A6	A4	-	B3	-	A3
	60%	X	A6	A4	-	C2	-	A2
醋酸 Acetic acid	20%	A2	A6	B1	A2	A2	A5	A4
	80%	B1	A6	X	-	-	A5	A4
氢氧化钠 Sodium hydroxide	20%	A3	A6	B1	B2	A3	-	A3
	50%	A3	A6	X	B1	A4	-	A3
溴水 Bromine water		C1	A3	A2	-	X	A1	A2
乙醇 Ethyl alcohol		A2	A3	A3	X	B3	A3	A5
丙酮 Acetone		A2	A6	X	-	B2	A3	A5
氟里昂12 Freon 12		X	A6	A1	X	B1	A4	A4
氯化铝 Aluminum chloride		A4	A6	A5	B4	A4	A4	A5
氨水 Ammonia liquid		A1	A6	C1	B4	B3	A3	A5
王水 Aqua regia		C2	A5	B2	-	C2	A4	-
甲醛 Formaldehyde		A4	A6	A4	X	A4	A4	A5
汽油 Gasolines		X	A6	B3	B3	X	A4	A6
煤油 Kerosene		A1	A6	A4	B1	X	A4	A6
甲醇 Methyl alcohol		A3	A6	B2	B4	A3	A5	A6
甲苯 Toluene		C1	A4	B1	-	X	A5	A4
三氯乙烯 Trichloroethylene		C1	A6	A1	-	X	A4	A6
二甲苯 Xylene		X	A6	B1	-	X	A5	A5
无水硝酸 Anhydrous nitrate		C1	A3	A1	-	X	A5	A2
发烟硫酸 Oleum		X	A6	A4	-	X	A5	A2
氢氧化钾 Potassium hydroxide		A4	A6	B1	C2	A5	-	A6

- 抗化学腐蚀标签注释: A—优秀 Excellent B—好 Good C—一般 Average X—不能接受 Unacceptable -—不能用 Nunsable
Chemical Corrosion Resistance: A—优秀 Excellent B—好 Good C—一般 Average X—不能接受 Unacceptable -—不能用 Nunsable
- 液体最高温度标签注释: 1—20°C(68F) 2—40°C(104F) 3—60°C(140F) 4—80°C(176F) 5—100°C(212F) 6—120°C(248F)
Maximum liquid temperature: 1—20°C(68F) 2—40°C(104F) 3—60°C(140F) 4—80°C(176F) 5—100°C(212F) 6—120°C(248F)
- 注: 9 5 陶瓷 - 含氧化铝 9 5 % 的陶瓷 Note: 95 Ceramic - referring to ceramic containing 95% alumina.